

SERIES

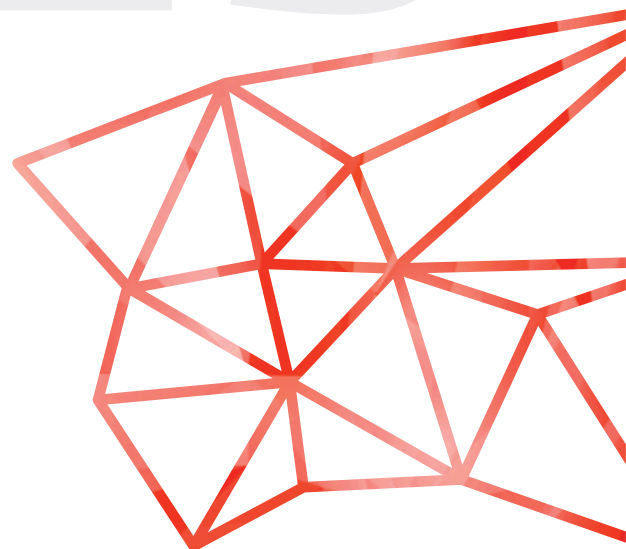

06

ACESSÓRIOS

ACCESSORIES

SÓRIOS

-
- 166** **ACESSÓRIOS PARA VITRINES**
ACCESSORIES FOR SHOWCASES
- 180** **CALHAS, CREMALHEIRAS, SUPORTES E ACESSÓRIOS**
*SLIDING DOOR TRACKS, RACKS, SUPPORTS, BRACKETS
AND ACCESSORIES*
- 192** **ACESSÓRIOS PARA EQUIPAMENTOS REFRIGERADOS**
ACCESSORIES FOR REFRIGERATED EQUIPMENTS
- 196** **ACESSÓRIOS PARA ESPAÇOS DE CONSERVAÇÃO
E PREPARAÇÃO DE ALIMENTOS**
ACCESSORIES FOR STORAGE AND FOOD PREPARATION AREAS
- 207** **TUBOS E VÁLVULAS DE ESGOTO**
DRAIN TUBES AND VALVES
- 209** **FECHOS E FECHADURAS**
LATCHES AND LOCKS
- 216** **PERFIS DE PLÁSTICO E BORRACHA**
PLASTIC AND RUBBER PROFILES
- 222** **SUPORTES, BASES, LIGAÇÕES E REMATES DE TUBO**
*TUBE SUPPORTS, MOUNTING BASES, CONNECTORS
AND END CAPS*
- 227** **CLIPS PARA VIDRO**
GLASS CLAMPS
- 229** **EMBELEZADORES**
COVERS

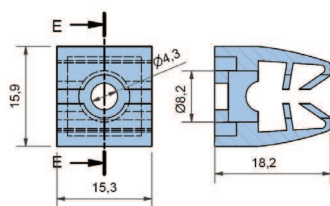

AC.1083

Suporte em polipropileno(PP) cinza para sonda de termostato

Grey polypropylene(PP) support for thermostat probe

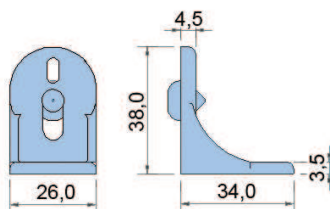

AC.1009 G

Suporte grande em policarbonato(PC) transparente para vidro de vitrine

AC.1021 Incluído

Large transparent polycarbonate(PC) support for showcase glass

AC.1021 Included

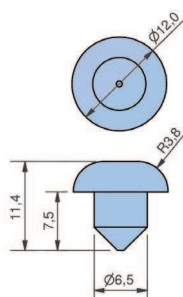

AC.1021

Piton em PVC transparente para **AC.1009 G**

Transparent PVC stud for AC.1009 G

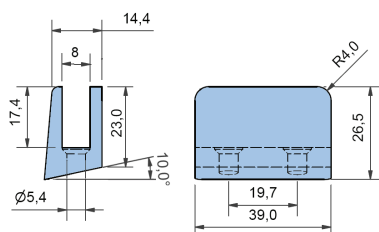

AC.1010 - AC.1010 C

Suporte inclinado em poliamida (PA) para vidro de vitrine

Slanted polyamide (PA) support for showcase glass

AC.1010 - Preto / Black

AC.1010 B - Branco / White

AC.1010 C - Cinza / Grey

Outras cores sob consulta
Other colours upon request



AC.1011 - AC.1011 B

Suporte direito em poliamida (PA) para vidro de vitrine

Straight polyamide (PA) support for showcase glass

- AC.1011** - Preto / Black
- AC.1011 B** - Branco / White
- AC.1011 C** - Cinza / Grey

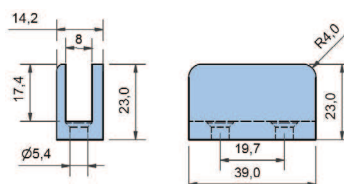

Outras cores sob consulta
Other colours upon request

AC.1077

Suporte inclinado em policarbonato (PC) para vidro de vitrine

Slanted transparent polycarbonate (PC) support for showcase glass

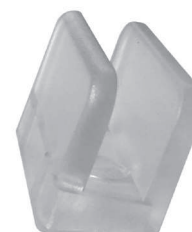
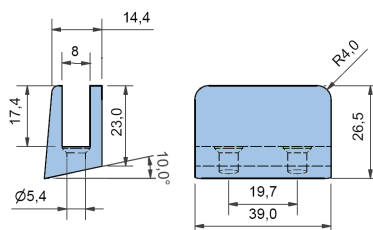

167

AC.1078

Suporte direito em policarbonato (PC) para vidro de vitrine;

Straight transparent polycarbonate (PC) support for showcase glass

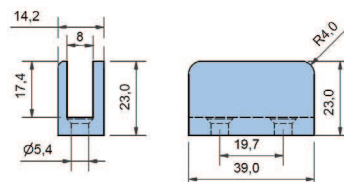

AC.1533

Suporte em poliamida (PA) preto para vidro de vitrine

Straight black polyamide (PA) support for showcase glass

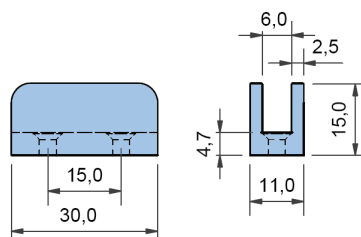

Outras cores sob consulta
Other colours upon request

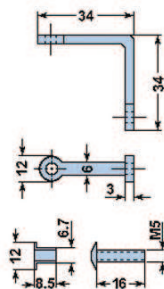

AC.1012

Ligação dupla em latão niquelado para vidro
(inclui casquilhos e parafusos de inox)

*Nickel-plated brass double joint for glass
(includes bushings and stainless steel screws)*

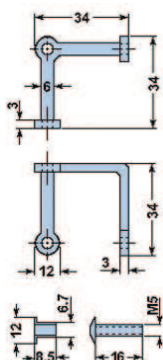

AC.1013

Ligação tripla em latão niquelado para vidro
(inclui casquilhos e parafusos de inox)

*Nickel-plated brass triple joint for glass
(includes stainless steel bushings and screws)*

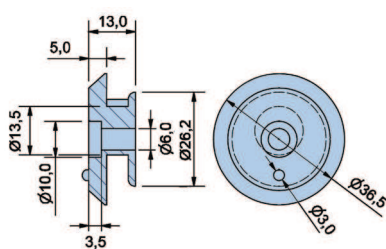

AC.1018 - AC.1018 B

Excêntrico em poliamida (PA) para vitrine

Polyamide (PA) eccentric support for showcase glass

AC.1018 - Preto / Black

AC.1018 B - Branco / White

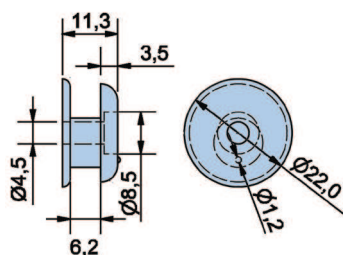

AC.1019 - AC.1019 B

Excêntrico em poliamida (PA) para vitrine

Polyamide (PA) eccentric support for showcase glass

AC.1019 - Cinza / Grey

AC.1019 B - Branco / White

AC.1020

Excêntrico em poliamida (PA) preto para fecho de vidro frontal de vitrine

Black polyamide (PA) eccentric support to connect showcase glass

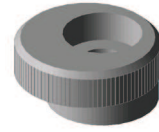
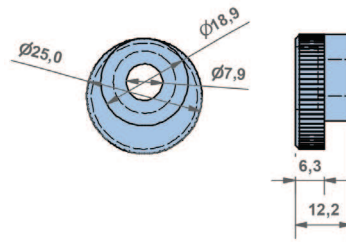

AC.1535

Suporte em poliamida (PA) cinza para vidro

Grey polyamide (PA) support for glass

AC.1535-1

Suporte em policarbonato (PC) transparente para vidro

Transparent polycarbonate (PC) support for glass

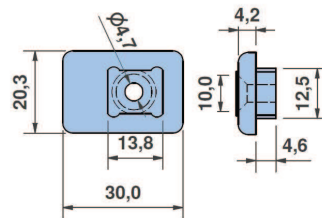

AC.1044

Parafuso M10x10mm em poliamida (PA) preta

M10x10mm black polyamide (PA) screw

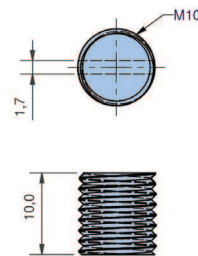

AC.1053

Conjunto de parafuso M5x20mm e porca em inox com casquilho para ligação de vidro

Stainless steel M5x20 screw and nut with bushing for glass connection

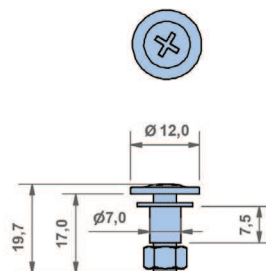

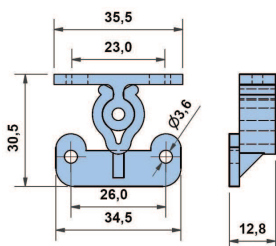

AC.1058 PA

Fecho em poliamida (PA) cinza para portas, gavetas e armários

Grey polyamide (PA) snap latch for drawers, doors and cabinets

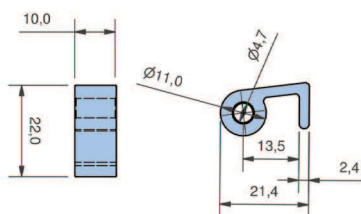

AC.1061

Gancho em acetil branco para vidro de vitrine

White acetal hook for showcase glass

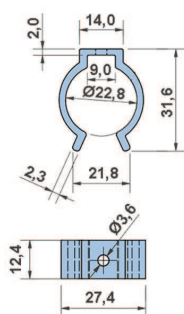

AC.1062

Suporte em acetil branco para lâmpada

White acetal support for lamp

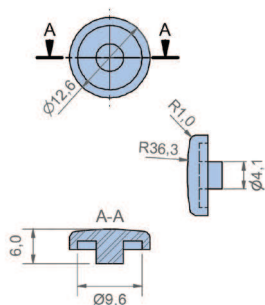
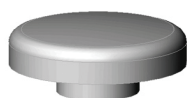

AC.1080 - AC.1080 CA

Tampão em poliamida (PA) para rebite de 4mm

Polyamide (PA) cap for 4mm rivet

AC.1080 - Branco / White

AC.1080 C - Cinza / Grey

AC.1080 CA - Castanho / Brown

AC.1081 - AC.1081 P

Tapa furos em poliamida (PA)

Polyamide (PA) hole cover

AC.1081 - Branco / *White*

AC.1081 C - Cinza / *Grey*

AC.1081 CA - Castanho / *Brown*

AC.1081 P - Preto / *Black*

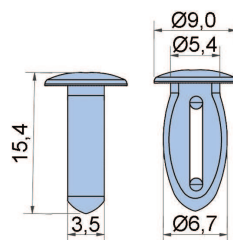

AC.1214

Ligação dupla em latão niquelado para vidro
(inclui duas anilhas em PVC transparente)

*Nickel-plated brass double joint for glass
(includes 2 transparent PVC washers)*

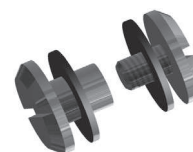
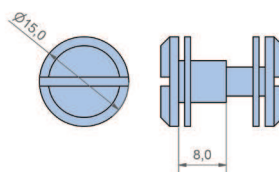

171

AC.1215

Par de dobradiças em inox para tampa de vitrine
Fornecido com parafusos e porcas

*Lid cover bracket assembly
Supplied with pivot screws and pins*

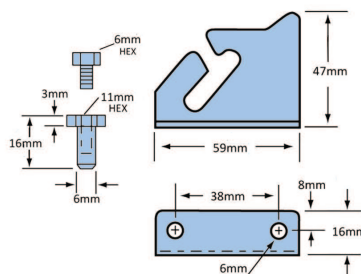

COMPONENT
HARDWARE

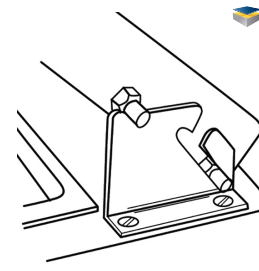

EXEMPLO DE APLICAÇÃO
EXAMPLE OF APPLICATION

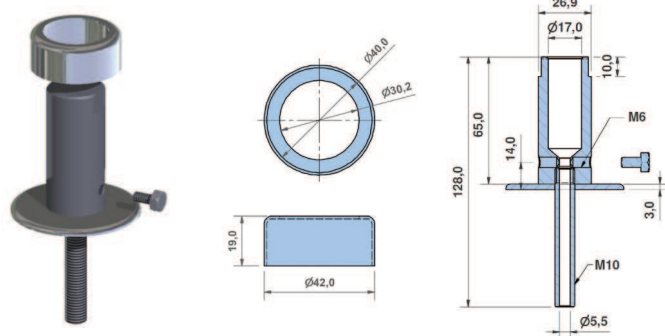

DV.2650

Kit base suporte Ø60x128mm
(permite a passagem de um cabo por dentro)

Support base kit Ø60x128mm
(allows passage of one cable inside)

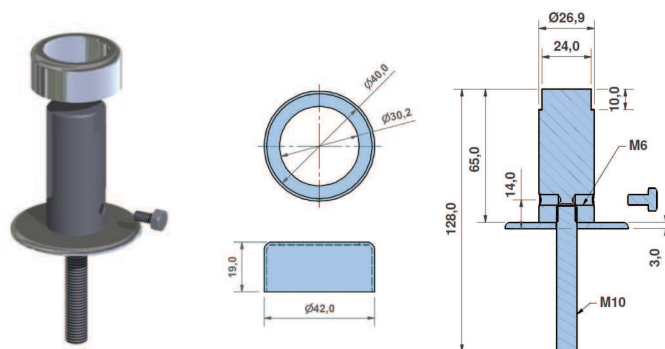

DV.2651

Kit base suporte Ø60x128mm

Support base kit Ø60x128mm

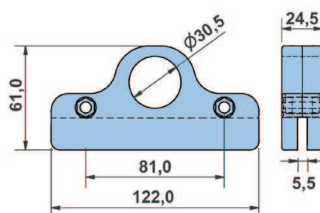

AC.1265 - AC.1265 P

Suporte de self em poliamida (PA) para vidro de vitrine
Espessura vidro 6/8mm

Polyamide (PA) support for showcase glass
6/8mm glass thickness

AC.1265 - Cinza / Grey
AC.1265 P - Preto / Black

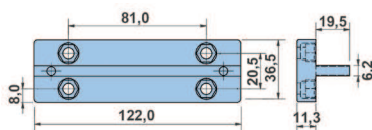

AC.1266 - AC.1266 P

Suplemento de self em poliamida (PA) para **AC.1265**

Polyamide (PA) supplement for **AC.1265**

AC.1266 - Cinza / Grey
AC.1266 P - Preto / Black

AC.1267 - AC.1267 P

Suporte/ligação de self em poliamida (PA) para vidro de vitrine
Espessura vidro 6/8mm

*Polyamide (PA) connection/support for showcase glass
6/8mm glass thickness*

AC.1267 - Cinza / Grey
AC.1267 P - Preto / Black

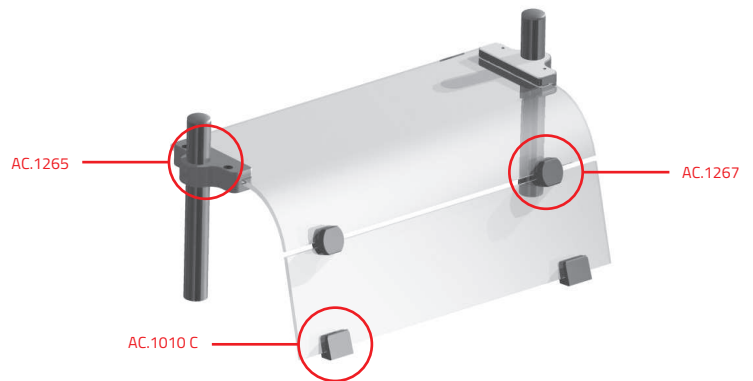
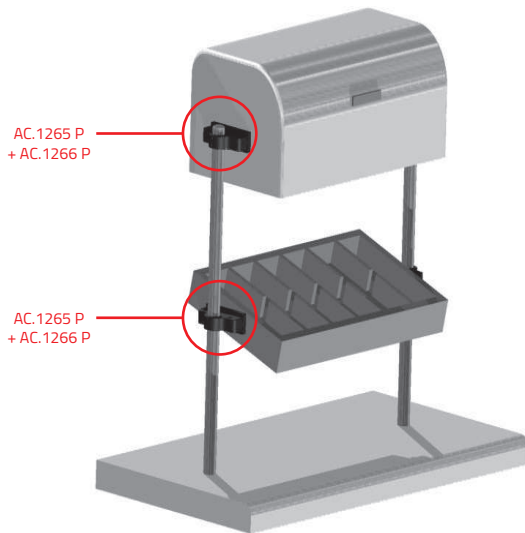
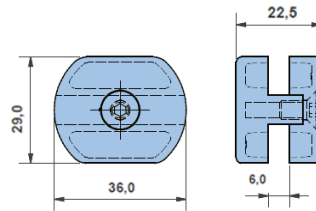

EXEMPLO DE APLICAÇÃO
EXAMPLE OF APPLICATION

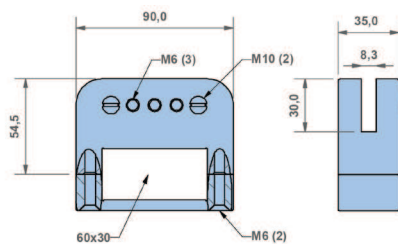
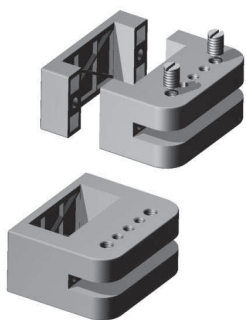

AC.1269-1 - AC.1269-1 P

Suporte de self em poliamida (PA) para vidro de vitrine
Espessura vidro 8mm

*Polyamide (PA) support for showcase glass
8mm glass thickness*

AC.1269-1 - Cinza / Grey
AC.1269-1 P - Preto / Black

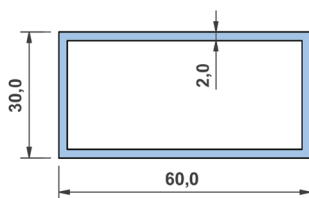
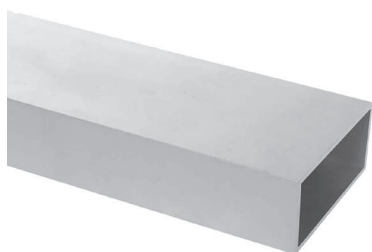

AC.1286

Perfil de alumínio anodizado cinza 60x30x2 com 5,8mt

Grey anodized aluminium profile 60x30x2 with 5,8mt

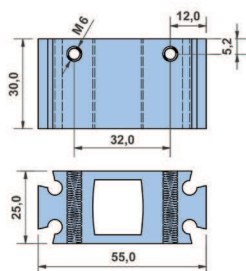
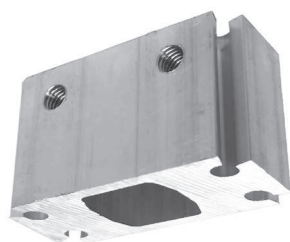

AC.1287

Base suporte de prumo em alumínio

Aluminium support base for profile

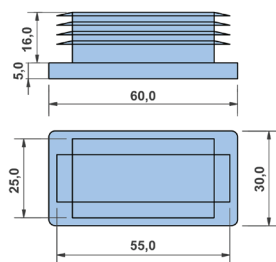

TC.6030 Z C

Tampão plástico cinza 60x30mm

Grey plastic cap for rectangular tube 60x30

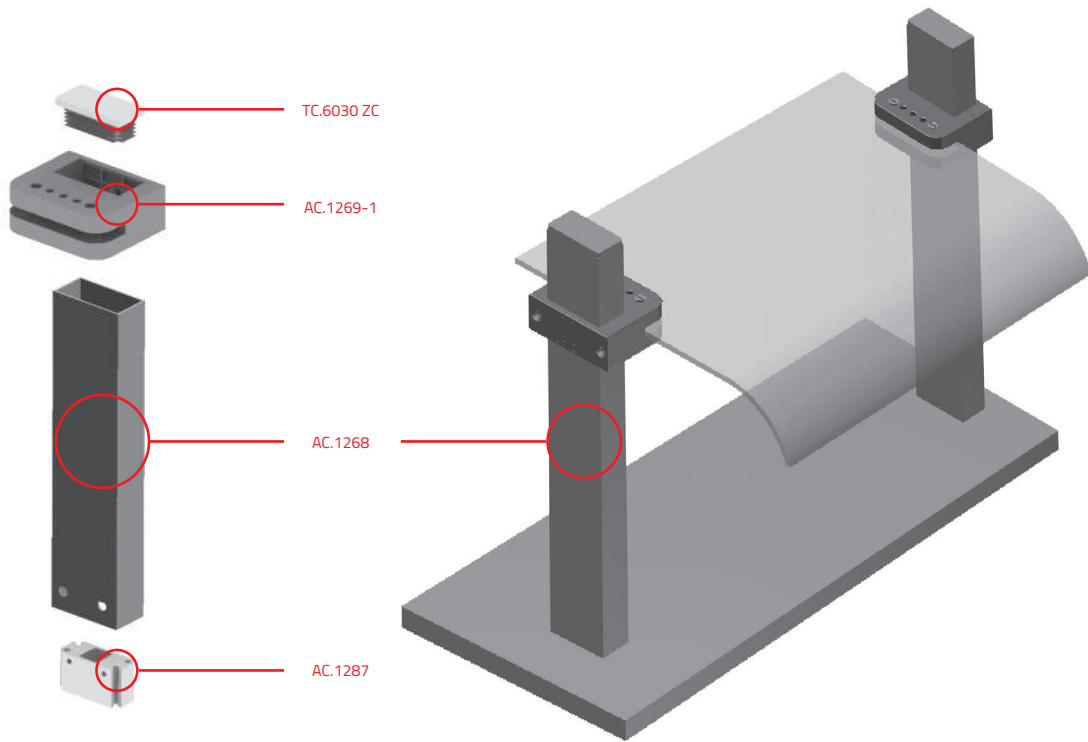

MONTAGEM DA BASE SUPORTE
ASSEMBLY OF BASE SUPPORT

EXEMPLO DE APLICAÇÃO
EXAMPLE OF APPLICATION

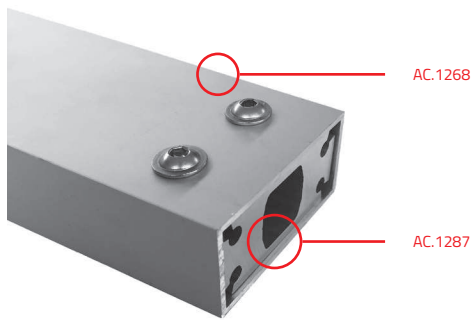

FIXAÇÃO DA BASE AO PERFIL
APPLICATION OF BASE ON PROFILE

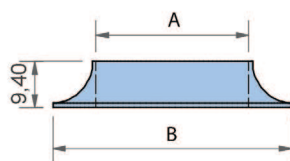

EP.C.01.30.PN - EP.C.01.38.PN

Base em poliamida (PA) preta para remate de tubo redondo

Black polyamide (PA) base for finishing round tube

	$\varnothing A$	$\varnothing B$
EP.C.01.30.PN	30	47
EP.C.01.38.PN	38	55

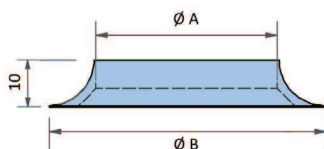

DV.2860 - DV.2061

Base em inox para remate de tubo

Stainless steel finishing for tube

	$\varnothing A$	$\varnothing B$
DV.2860	38.2	58.0
DV.2061	60.5	80.0

✓ Outras medidas sob consulta
Other dimensions upon request

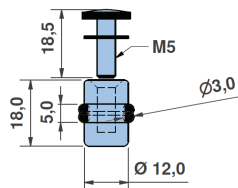

AC.1270

Acessório em latão cromado com parafuso para aplicar em vidro

Chrome plated brass accessory with screw for application on glass

✓ Opção: inox sob consulta
Option: stainless steel upon request

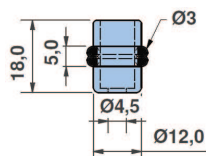

AC.1271

Acessório em latão cromado sem parafuso para aplicar em vidro

Chrome plated brass accessory without screw for application on glass

✓ Opção: inox sob consulta
Option: stainless steel upon request

AC.1272

Acessório em latão cromado com parafuso para aplicar em vidro

Chrome plated brass accessory with screw for application on glass

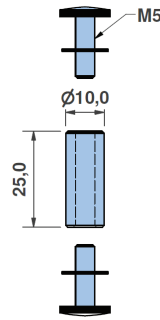

✓ Opção: inox sob consulta
Option: stainless steel upon request

AC.1273

Acessório em latão cromado com parafuso para aplicar em vidro

Chrome plated brass accessory with screw for application on glass

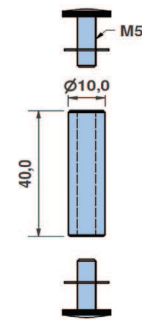

✓ Opção: inox sob consulta
Option: stainless steel upon request

AC.1274

Acessório em latão cromado com parafuso para aplicar em vidro

Chrome plated brass accessory with screw for application on glass

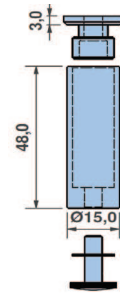

✓ Opção: inox sob consulta
Option: stainless steel upon request

AC.1275

Acessório em latão cromado com parafuso para aplicar em vidro

Chrome plated brass accessory with screw for application on glass

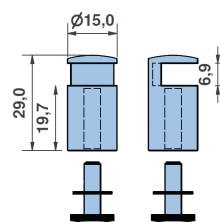

✓ Opção: inox sob consulta
Option: stainless steel upon request

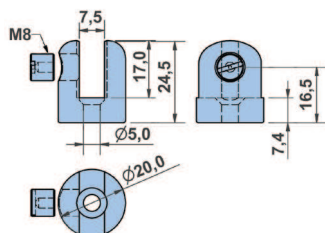

AC.1277

Acessório em latão cromado Ø20mm com rasgo de 7,5mm para aplicar em vidro

Chrome plated brass Ø20mm accessory with a 7,5mm opening for application on glass

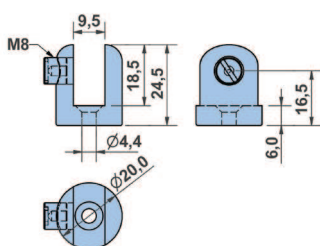

AC.1278

Acessório em latão cromado Ø20mm com rasgo de 9,5mm para aplicar em vidro

Chrome plated brass Ø20mm accessory with a 9,5mm opening for application on glass

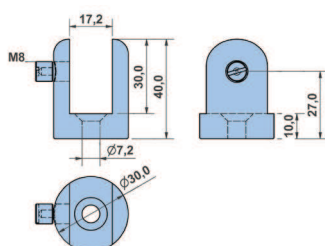

AC.1279

Acessório em latão cromado Ø30mm com rasgo de 17mm para aplicar em vidro

Chrome plated brass Ø30mm accessory with a 17mm opening for application on glass

PT.1300 - PT.1305

Porta em ABS para vitrine com perfil em PVC com magnético
Fornecida com dobradiças e fiéis

Opção: Fecho AC.1059

*ABS showcase doors with PVC gasket with magnet
Supplied with hinges and pins*

Option: Latch AC.1059

PT.1300 – Cinza claro / *Light grey*
PT.1301 – Cinza escuro / *Dark grey*
PT.1304 – Branca / *White*

Outras cores sob consulta
Other colours upon request



EXEMPLO DE APLICAÇÃO
EXAMPLE OF APPLICATION



DOBRADIÇA
HINGE

PEGA
PULL



PORTA
DOOR



INTERIOR PORTA
DOOR INTERIOR

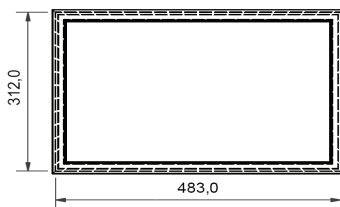

PT.1320 - BORRACHA PARA PORTA
PT.1320 - DOOR GASKET

FECHO AC.1058 PA
LATCH AC.1058 PA

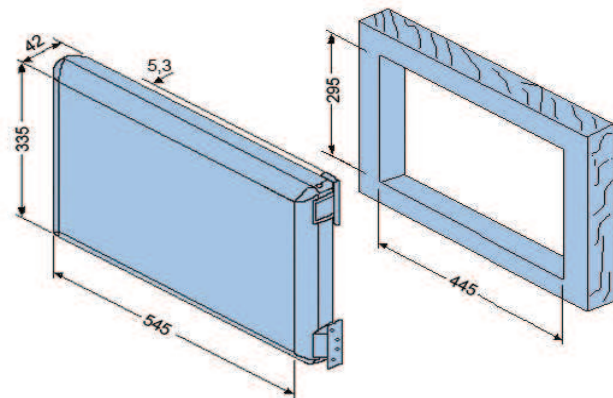

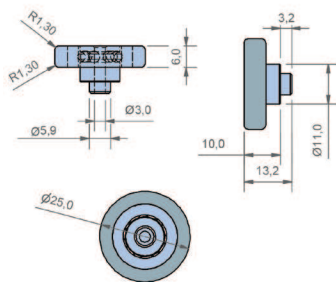
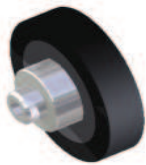

AC.1007

Rolamento em aço zincado/poliamida (PA) para portas deslizantes

Zinc plated steel/polyamide (PA) ball bearing for sliding doors

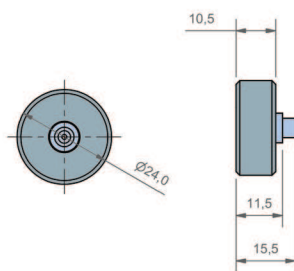

AC.1008

Rodizio em poliamida(PA) com cravo inox para corredeiras

Polyamide(PA) bearing with stainless steel stud for drawer slides

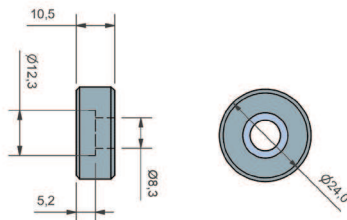

AC.1040

Rodizio em poliamida(PA) para AC.1008 (parte exterior)

Polyamide(PA) bearing without stud for AC.1008

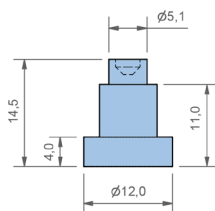
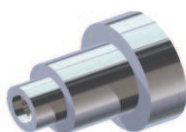

AC.1040-1

Roleto em inox para rodizio AC.1008

Stainless steel stud for AC.1008 bearing

AC.2583

Rolamento em aço zincado/poliamida (PA) com cravo para portas deslizantes

Zinc plated steel/polyamide (PA) ball bearing with stud for sliding doors

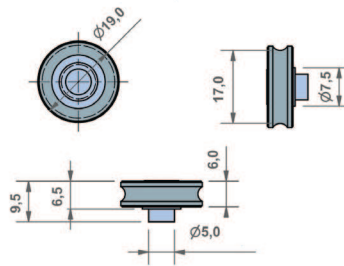

AC.2582-1

Rolamento em aço zincado/poliamida (PA) para portas deslizantes com rosca M4

Zinc plated steel/polyamide (PA) ball bearing for sliding doors with M4 thread

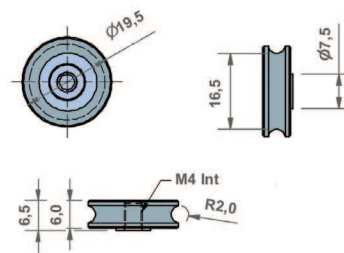

AC.2580

Rolamento em aço zincado/poliamida (PA) para portas deslizantes com rosca M5

Zinc plated steel/polyamide (PA) ball bearing for sliding doors with M5 thread

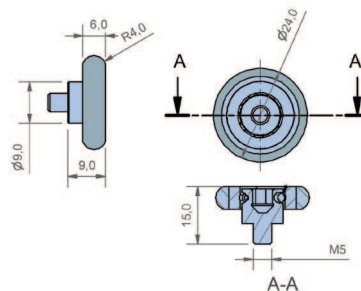

AC.2585

Rolamento em aço zincado com cravo para portas deslizantes

Zinc plated ball bearing with stud for sliding doors

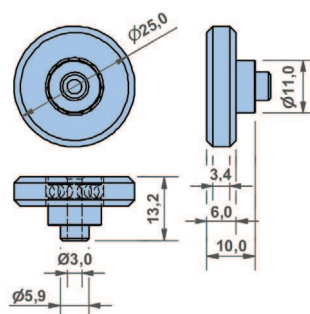

AC.1182

Rolamento Ø30 em poliamida (PA)/aço zincado
Inclui parafuso M5

*Ø30 polyamide (PA)/zinc plated steel bearing
Includes M5 screw*

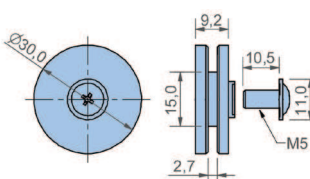

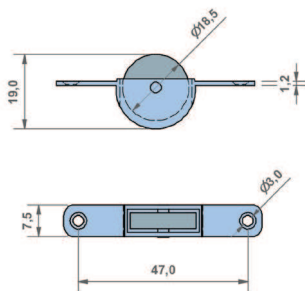

AC.1001

Suporte em aço zincado com rolete em poliamida (PA) para portas deslizantes

Zinc plated steel support with polyamide (PA) bearing for sliding doors

AC.1001 I

Suporte em aço zincado com rolete em inox para portas deslizantes

Zinc plated steel support with stainless steel bearing for sliding doors

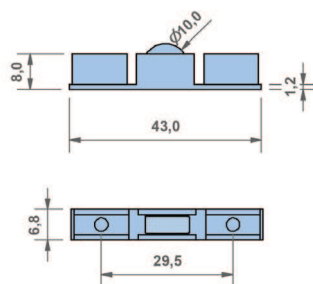

AC.1027

Roleta aço zincado com parafusos para calha de alumínio

Zinc plated steel bearing with screws for aluminium track

AC.1027 I

Roleta em aço zincado com rolamento em inox para calha de alumínio

Zinc plated steel support with stainless steel ball bearing for aluminium track

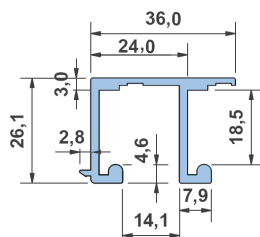
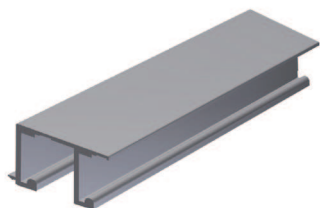

AC.1395 - 1397

Calha perfil alumínio 36mm para portas deslizantes

36mm sliding door track in extruded aluminium

AC.1395 - 6 Mts

AC.1396 - 2 Mts

AC.1397 - 3 Mts

AC.1415

Suporte em aço zincado para portas deslizantes, com rolamento (AC.2583)

Zinc plated steel support with (AC.2583) ball bearing for sliding doors

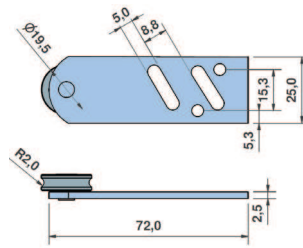

AC.1400 - 1403

Calha perfil alumínio 46mm para portas deslizantes

46mm sliding door track in extruded aluminium

AC.1400 - 6 Mts

AC.1402 - 2 Mts

AC.1403 - 3 Mts

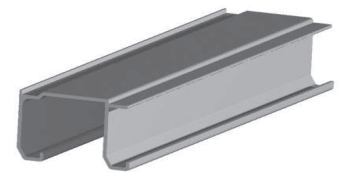
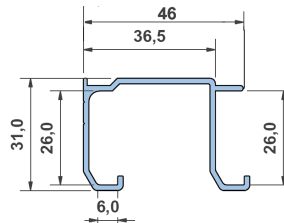

AC.1004

Suporte em aço zincado para portas deslizantes, com rolamento (AC.1007)

Zinc plated steel support with (AC.1007) ball bearing for sliding doors

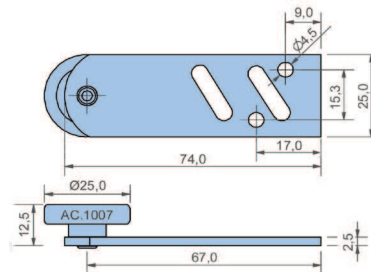

AC.1408

Suporte anterior em aço zincado para portas deslizantes, com rolamento (AC.1007)

Front zinc plated steel support with (AC.1007) ball bearing for sliding doors

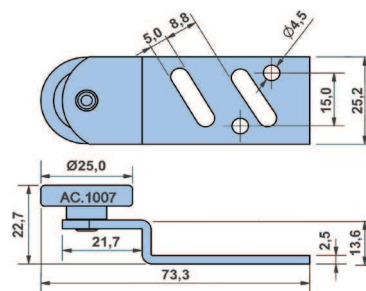

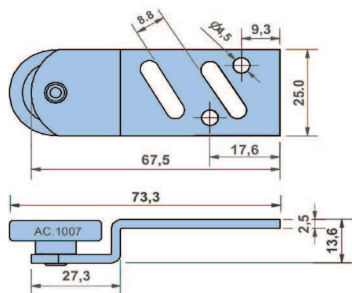

AC.1408-1

Suporte anterior em aço zincado para portas deslizantes, com rolamento (AC.1007)

Front zinc plated steel support with (AC.1007) ball bearing for sliding doors

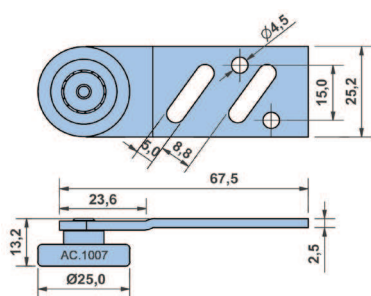

AC.1410

Suporte posterior em aço zincado para portas deslizantes, com rolamento (AC.1007)

Rear zinc plated steel support with (AC.1007) ball bearing for sliding doors

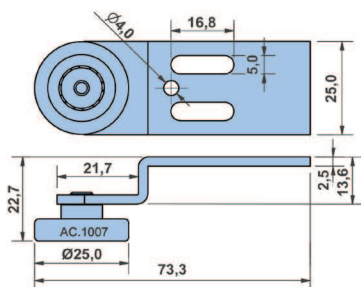

AC.1438

Suporte anterior em aço zincado para portas deslizantes com rasgo vertical e rolamento (AC.1007)

Front zinc plated steel support with (AC.1007) ball bearing for sliding doors with vertical groove

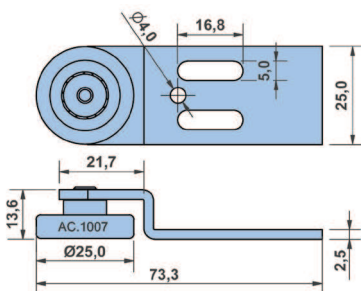

AC.1438-1

Suporte anterior em aço zincado para portas deslizantes com rasgo vertical e rolamento (AC.1007)

Front zinc plated steel support with (AC.1007) ball bearing for sliding doors with vertical groove



AC.1440

Suporte posterior em aço zincado para portas deslizantes com rasgo vertical e rolamento (AC.1007)

Rear zinc plated steel support with (AC.1007) ball bearing for sliding doors with vertical groove

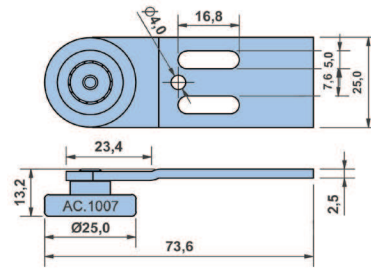

AC.1400 A AC.1403

AC.1395 A AC.1397

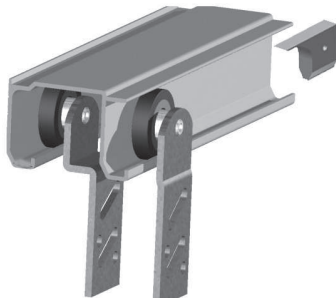

AC.1580



AC.1408 / AC.1438

AC.1410 / AC.1440

AC.1415

EXEMPLO DE APLICAÇÃO
EXAMPLE OF APPLICATION

185

AC.1445

Suporte anterior em aço zincado para portas deslizantes, com rolamento em aço zincado (AC.2585)

Front zinc plated steel support with (AC.2585) zinc plated steel ball bearing for sliding doors

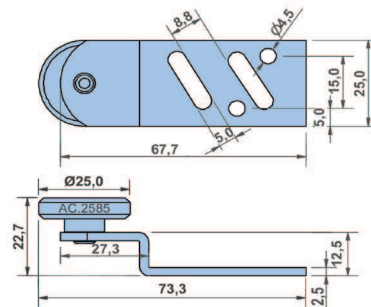

AC.1445-1

Suporte anterior em aço zincado para portas deslizantes, com rolamento em aço zincado (AC.2585)

Front zinc plated steel support with (AC.2585) zinc plated steel ball bearing for sliding doors

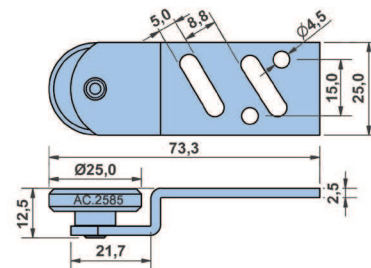

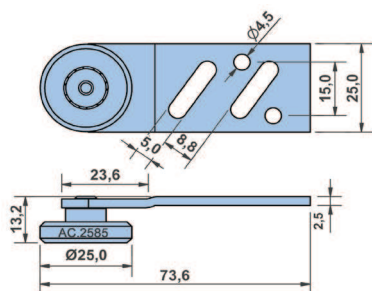

AC.1446

Suporte posterior em aço zincado para portas deslizantes, com rolamento em aço zincado (AC.2585)

Rear zinc plated steel support with (AC.2585) zinc plated steel ball bearing for sliding doors

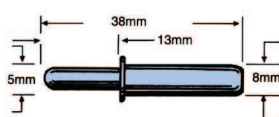

✓ Fornecido com anilha de fixação
Supplied with fixing washer

AC.1405

Pino guia com mola para portas deslizantes

Spring loaded guide pin for sliding doors

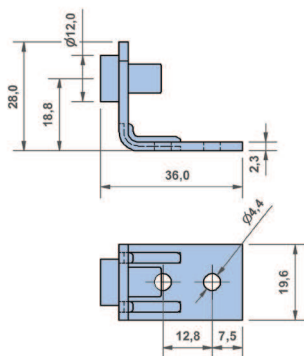

AC.1406

Batente de borracha para porta deslizante com suporte em aço zincado

Zinc plated steel door stop with rubber bumper

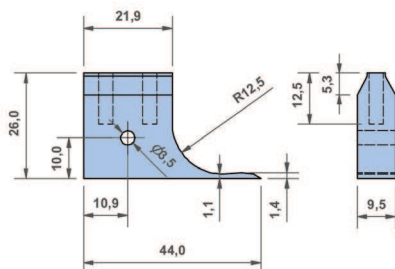
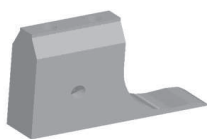

AC.1580

Bloqueio em poliamida(PA) branca para perfil AC.1400-1403

White polyamide(PA) block for tracks AC.1400-1403



AC.1411

Guia em poliamida (PA) cinza para portas deslizantes com 19mm

Grey polyamide (PA) door guide for 19mm sliding doors

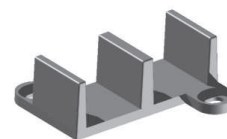
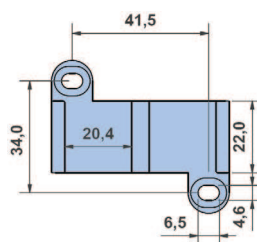

AC.1412

Guia em ABS/PC cinza para portas deslizantes com 13mm

Grey ABS/PC door guide for 13mm sliding doors

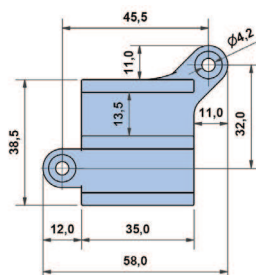

AC.1029 - 1034

Cremalheira em aço inoxidável AISI 304

Stainless steel AISI 304 pilaster

	A (mm)
AC.1029	1500
AC.1032	1000
AC.1034	2000

✓ Outros comprimentos sob consulta
Other lengths upon request

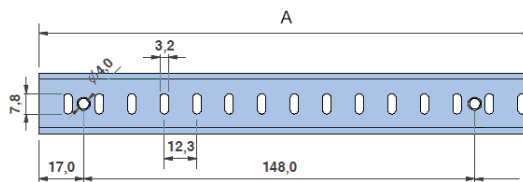

AC.1036 - 1038

Suportes de cremalheira em aço inoxidável AISI 304

Stainless steel AISI 304 holders for pilaster

	ESPESSURA (mm) THICKNESS (mm)
AC.1036	0.8
AC.1036-1	1.0
AC.1038	0.8
AC.1038-1	1.0

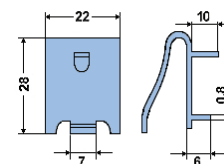
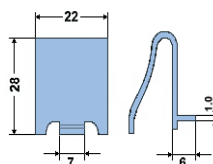

AC.1036 / AC.1036-1

AC.1038 / AC.1038-1

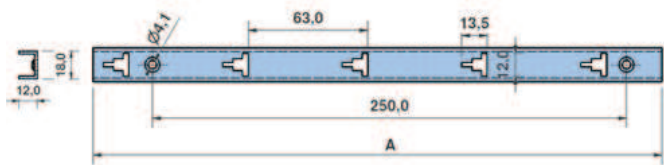

AC.1770 - 1772

Calha perfurada 18x12mm em alumínio natural

18x12mm natural aluminum pilaster

	A (mm)
AC.1770	530
AC.1771	1000
AC.1772	2000

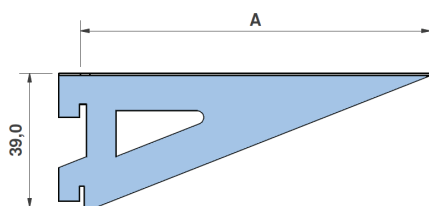
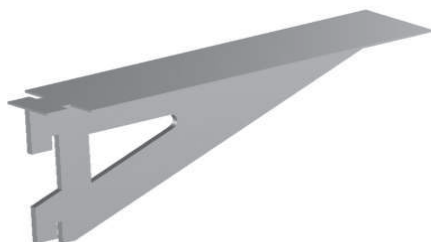

AC.1775 - 1782

Poleia sem rebordo para calha perfurada 18x12mm em alumínio natural

Natural aluminum bracket without flange for 18x12mm pilaster

	A (mm)
AC.1775	100
AC.1776	150
AC.1777	200
AC.1778	250
AC.1779	300
AC.1780	350
AC.1781	400
AC.1782	450

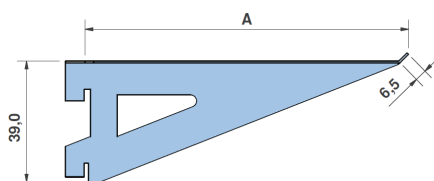
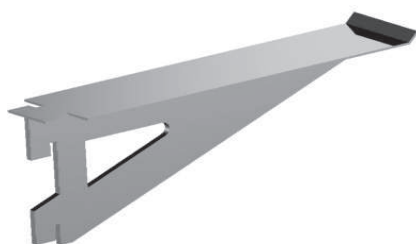

AC.1783 - 1790

Poleia com rebordo para calha perfurada 18x12mm em alumínio natural

Natural aluminum bracket with flange for 18x12mm pilaster

	A (mm)
AC.1783	100
AC.1784	150
AC.1785	200
AC.1786	250
AC.1787	300
AC.1788	350
AC.1789	400
AC.1790	450



AC.1650

Suporte dobrável e removível em zamak cromado com base em inox com 156x178mm

Capacidade de carga: 90kg em 2 suportes

Folding Removable Shelf Bracket in chrome plated zamak with stainless steel mount, 156x178mm

Load capacity: 90kg per 2 brackets

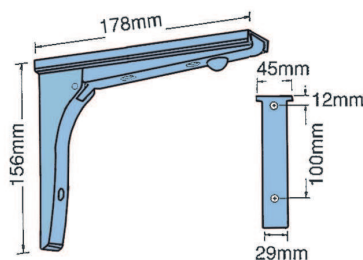

AC.1651

Suporte dobrável em inox AISI 304 com 89x190mm

Capacidade de carga: 68kg em 2 suportes

AISI 304 stainless steel folding bracket with 89x190mm

Load capacity: 68kg per 2 brackets

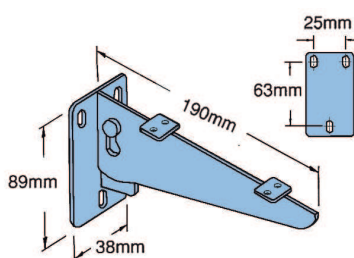

AC.1652

Suporte dobrável em inox AISI 304 com 250x220mm

Capacidade de carga: 90kg em 2 suportes

AISI 304 stainless steel folding bracket with 250x220mm

Load capacity: 90kg per 2 brackets

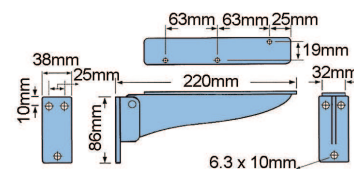

AC.1653

Suporte dobrável em inox AISI 304 com 86x309mm (para 3 tubos Ø25mm)

Capacidade de carga: 68kg em 2 suportes

AISI 304 stainless steel folding bracket with 86x309mm (for 3 tubes Ø25mm)

Load capacity: 68kg per 2 brackets

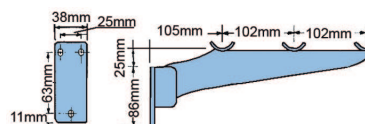

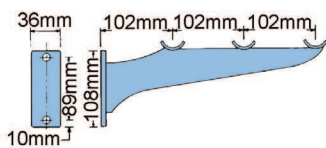

AC.1654

Suporte fixo em inox AISI 304 com 108x306mm (para 3 tubos Ø25mm)

Capacidade de carga: 90kg em 2 suportes

AISI 304 stainless steel bracket with 108x306mm (for 3 tubes Ø25mm)

Load capacity: 90kg per 2 brackets

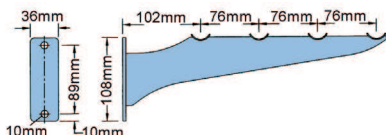

AC.1655

Suporte fixo em inox AISI 304 com 108x330mm (para 4 tubos Ø25mm)

Capacidade de carga: 90kg em 2 suportes

AISI 304 stainless steel bracket with 108x330mm (for 4 tubes Ø25mm)

Load capacity: 90kg per 2 brackets

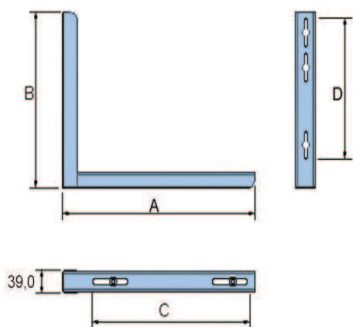

SP.4234 - SP.5539 I

Suportes para máquinas de ar condicionado

Opção: Porcas ajustáveis

Brackets for air conditioning machines

Option: Running nuts

	A	B	C	D	MATERIAL	CARGA (KG) LOAD (KG)
SP.4234	415	340	335	265	AÇO ZINCADO GALVANIZED STEEL	50
SP.4234 I	415	340	335	265	INOX STAINLESS STEEL	50
SP.4934	485	340	405	265	AÇO ZINCADO GALVANIZED STEEL	75
SP.4934 I	485	340	405	265	INOX STAINLESS STEEL	75
SP.5539	545	390	470	315	AÇO ZINCADO GALVANIZED STEEL	125
SP.5539 I	545	390	470	315	INOX STAINLESS STEEL	125

DV.2470 - 2475

Suportes em aço inox para prateleiras
Espessura Inox - 1.2mm

Stainless steel supports for shelves
Stainless steel thickness - 1.2mm

	A	B	C	D	E	F
DV.2470	430	38	16	25	-	-
DV.2471	530	38	16	25	-	-
DV.2472	630	38	20	25	-	-
DV.2473	635	8	20	25	-	-
DV.2474	730	38	20	25	-	-
DV.2475	635	8	-	-	15	28

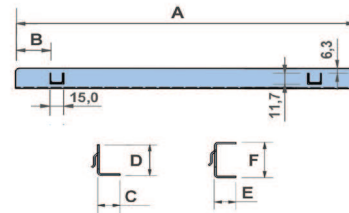

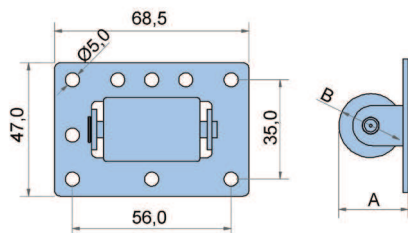

AC.1005 - 1006

Deslizador em aço zincado/ABS-PC para arcas

Zinc plated steel and ABS-PC roller for freezers

	A	ØB
AC.1005	23,0	19
AC.1006	24,5	23

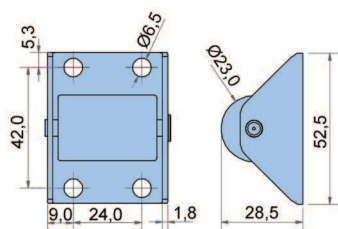
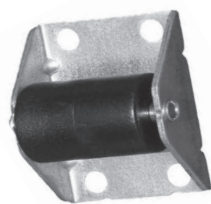

AC.1350

Deslizador em aço zincado/ABS-PC para arcas

Zinc plated steel and ABS-PC roller for freezers

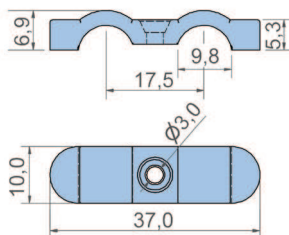

AC.1059 - AC.1059 B

Abraçadeira dupla em poliamida (PA) para cabo elétrico

Polyamide(PA) double clamp for electrical cords

AC.1059 - Preto / Black
AC.1059 B - Branco / White

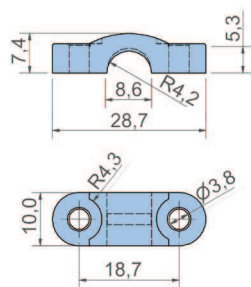

AC.1060 - AC.1060 B

Abraçadeira simples em poliamida (PA) para cabo elétrico

Polyamide(PA) single clamp for electrical cords

AC.1060 - Preto / Black
AC.1060 B - Branco / White

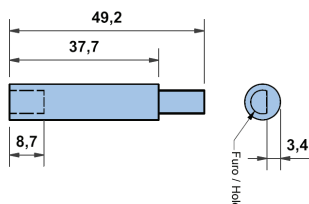

AC.1175

Suplemento em ABS para termostato

ABS supplement for thermostat

AC.1195-4

Kit bandeja de evaporação em alumínio
 Resistência com sistema PTC, 220V - 230W
 Diâmetro da resistência - 12mm
 Capacidade da bandeja - 1,9L
 Capacidade de evaporação - 0,200 - 0,250L/h
 Inclui parafusos de fixação

*Aluminium water evaporation tray kit
 PTC system resistance, 220V - 230W
 Resistance diameter - 12mm
 Capacity - 1,9L
 Evaporation capacity - 0,200 - 0,250L/h
 Fixation screws included*

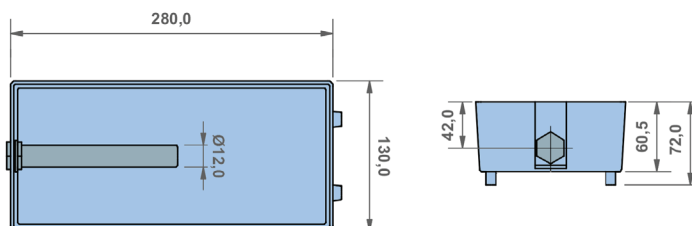
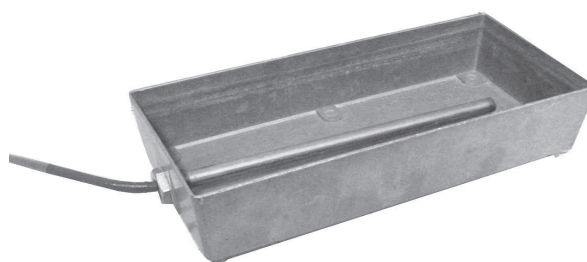

AC.1199

Bandeja de evaporação em alumínio sem resistência
Aluminium water evaporation tray without electrical resistance

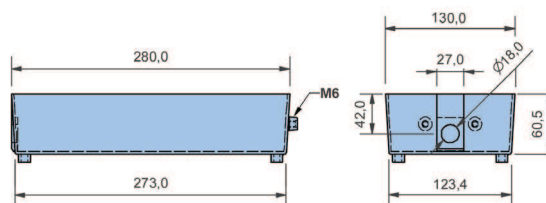

AC.1197-4

Kit bandeja de evaporação em PP com FV
 Resistência com sistema PTC, 220V - 230W
 Diâmetro da resistência - 12mm
 Capacidade da bandeja - 1,5L
 Capacidade de evaporação - 0,200 - 0,250L/h

*PP with GF water evaporation tray kit
 PTC system resistance, 220V - 230W
 Resistance diameter - 12mm
 Capacity - 1,5L
 Evaporation capacity - 0,200 - 0,250L/h*

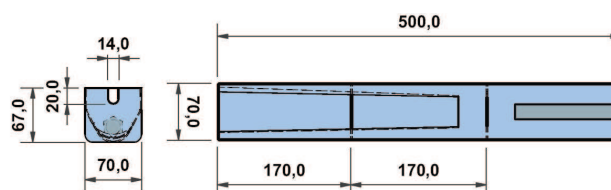
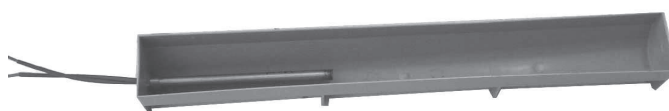

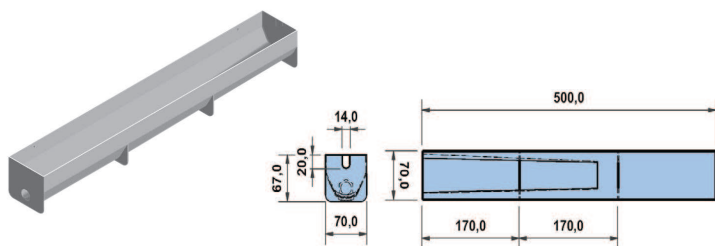

AC.1198

Bandeja de evaporação em polipropileno (PP) sem resistência

Polypropylene (PP) water evaporation tray without electrical resistance

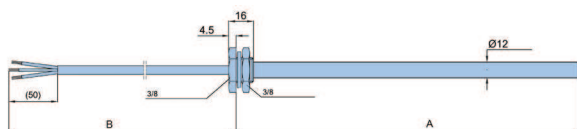

AC.1203-3 - AC.1203-4

Resistência tipo cartucho de 220V

Cartridge type resistance - 220V

	A	B	W
AC.1203-3	240	1100	500
AC.1203-4	175	1500	230

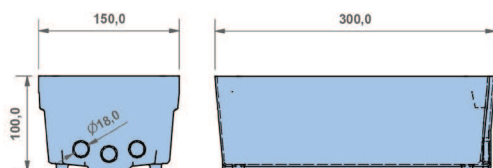

AC.1205

Bandeja de evaporação em ABS auto-extinguível preto para uso com resistência de 230W

Evaporation tray in self-extinguishing black ABS for use with 230W PTC resistance

AC.1206

Bandeja de evaporação em policarbonato(PC) cinza com furo para colocação de resistência PTC

Evaporation tray in grey polycarbonate(PC) with hole for application of PTC resistance

AC.1225

Tampa em poliamida (PA) para furos 90x50mm

Polyamide (PA) cover for 90x50mm holes

AC.1225 - Branco / *White*

AC.1225 C - Cinza / *Grey*

AC.1225 P - Preto / *Black*

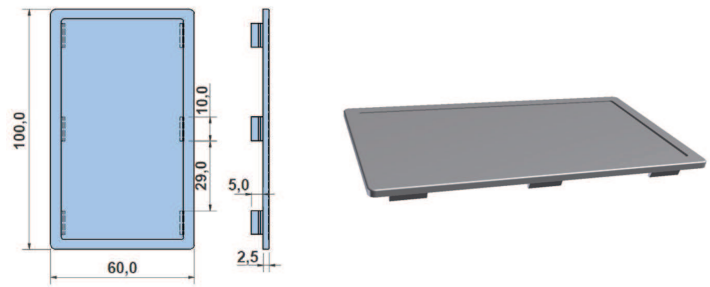

AC.1346

Válvula de equilíbrio de pressão para armários

Pressure balancing valve for cabinets

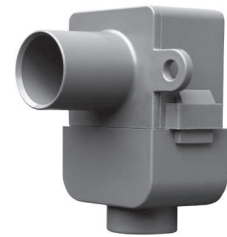
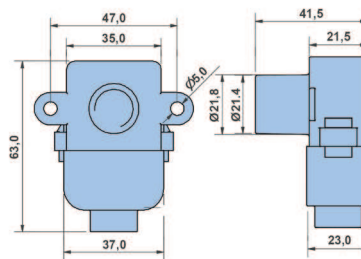

195

AC.1800 - AC.1801

Pedal em inox para portas

Stainless steel foot pedal for doors

AC.1800 - Direito / *Right*

AC.1801 - Esquerdo / *Left*

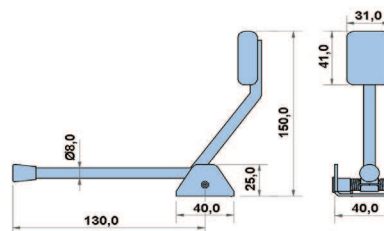



AC.1253

Kit superior para mesas desmontáveis

A - Para prumos em tubo de 40x40mm com espessura de 0,9 a 1,2mm

Nota: Kits fornecidos com parafusos e anilhas

Superior dismantable table kit

A - For 40x40mm tube with 0,9 to 1,2mm thickness

Note: Kits supplied with screws and washers



AC.1254

Kit inferior para mesas desmontáveis

A - Para prumos em tubo de 40x40mm com espessura de 0,9 a 1,2mm

Nota: Kits fornecidos com parafusos e anilhas

Inferior dismantable table kit

A - For 40x40mm tube with 0,9 to 1,2mm thickness

Note: Kits supplied with screws and washers



AC.1253



AC.1254

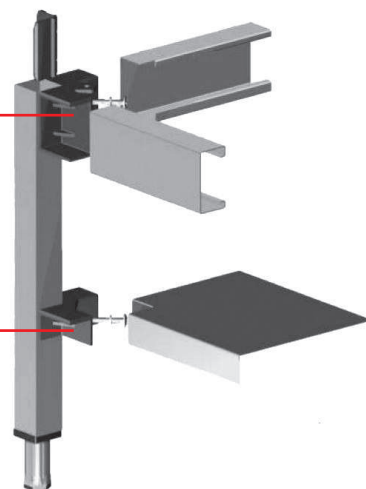

Consulte-nos para tubo 40x40 com furação para kit de mesas
Consult us for 40x40 tube with holes for table kit

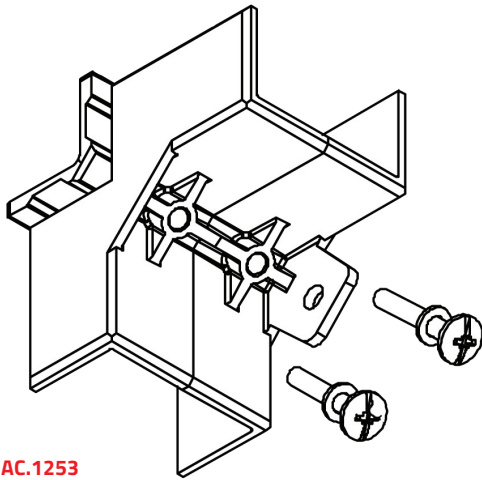

AC.1253
KIT SUPERIOR
SUPERIOR KIT

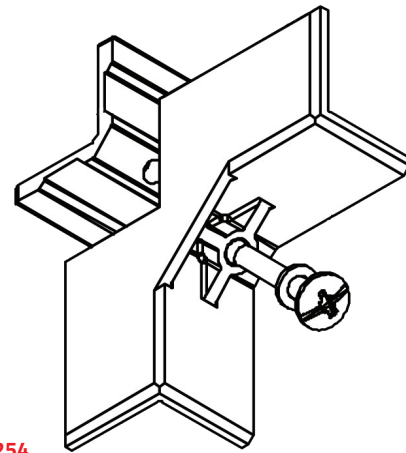

AC.1254
KIT INFERIOR
INFERIOR KIT

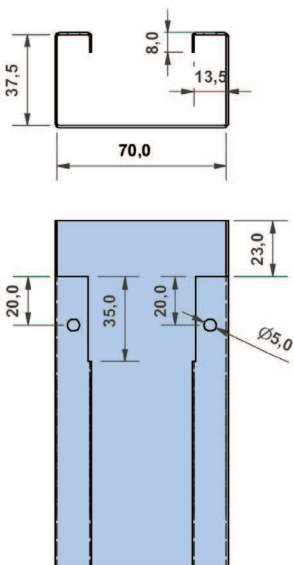
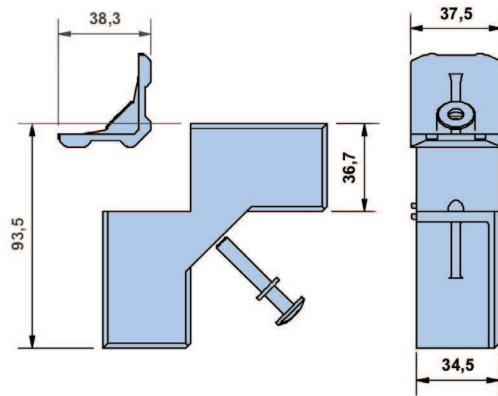
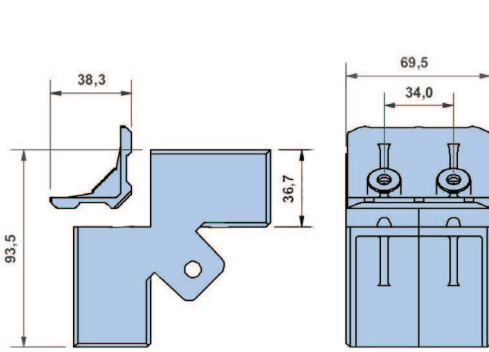

**EXEMPLO DE DIMENSÕES PARA SUPORTES
LATERAIS DO TAMPO**
EXAMPLE OF DIMENSIONS LATERAL TABLE SUPPORT

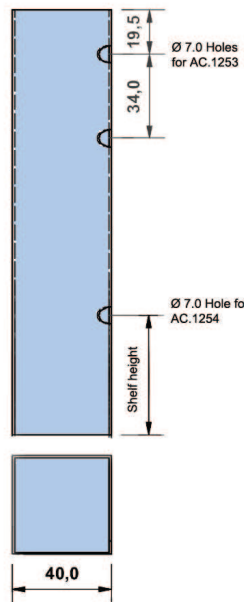
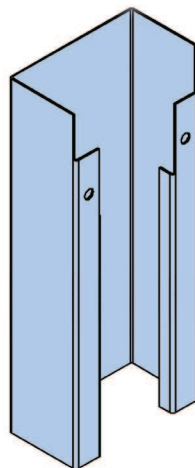

**EXEMPLO DE DIMENSÕES E POSIÇÃO DE FUROS
PARA APLICAÇÃO DOS KITS**
EXAMPLE OF DIMENSIONS AND POSITION OF HOLES
NECESSARY FOR APPLICATION OF THE KITS ON THE
TABLE LEGS

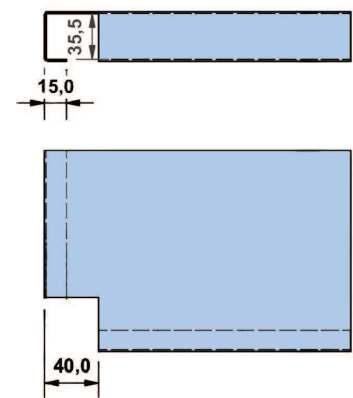

EXEMPLO DE DIMENSÕES PARA FABRICO DE PRATELEIRA
EXAMPLE OF DIMENSIONS FOR SHELF PRODUCTION

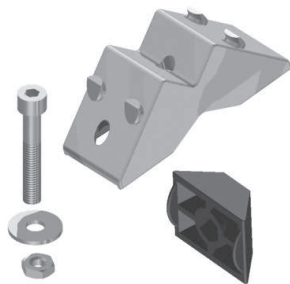

Composição do Kit:
 1 - Canto AC.1255-1
 1 - Parafuso M8x40mm+anilha+porca
 1 - Interior plástico

Kit composition:
 1 - AC.1255-1 corner
 1 - M8x40mm screw+washer+nut
 1 - Plastic interior

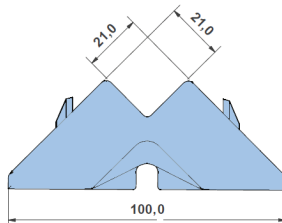

AC.1255

Kit para mesas desmontáveis simples
 Para prumos em tubo 40x40mm e travessas
 40x20mm ou 40x25mm

*Simple dismountable table kit
 For 40x40mm leg tube and 40x20mm or 40x25mm crossbar*

AC.1255-1

Canto em zamak para kits AC.1255 e AC.1256

Zamak corner for kits AC.1255 and AC.1256



Composição do Kit:
 2 - Cantos AC.1255-1
 2 - Parafusos M8x30mm+anilhas+porcas
 1 - Interior intermédio plástico

Kit composition:
 2 - AC.1255-1 corners
 2 - M8x30mm screws+washers+nuts
 1 - Intermediate plastic interior

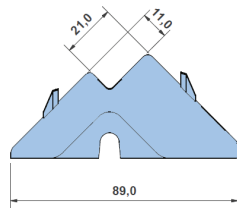

AC.1256

Kit para mesas desmontáveis triplas
 Para prumos em tubo 40x40mm e travessas
 40x20mm e travessa central 40x10mm

*Triple dismountable table kit
 For 40x40mm leg tube and 40x20mm or 40x25mm crossbar,
 and 40x10mm central crossbar*

AC.1255-10

Canto em zamak para kit AC.1257

Zamak corner for kit AC.1257



Composição do Kit:
 2 - Cantos AC.1255-10
 2 - Parafusos M8x30mm+anilhas+porcas
 1 - Interior intermédio plástico

Kit composition:
 2 - AC.1255-10 corners
 2 - M8x30mm screws+washers+nuts
 1 - Intermediate plastic interior

AC.1257

Kit em zamak para mesas desmontáveis triplas
 Para prumos em tubo 40x40mm, travessas 40x20mm ou
 40x25mm e travessa central 40x20mm

*Triple dismountable table kit
 For 40x40mm leg tube and 40x20mm or 40x25mm crossbar,
 and 40x20mm central crossbar*

AC.1255

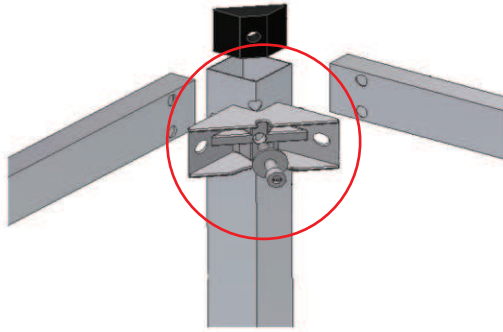

EXEMPLO DE APLICAÇÃO
EXAMPLE OF APPLICATION

AC.1256 - AC.1257

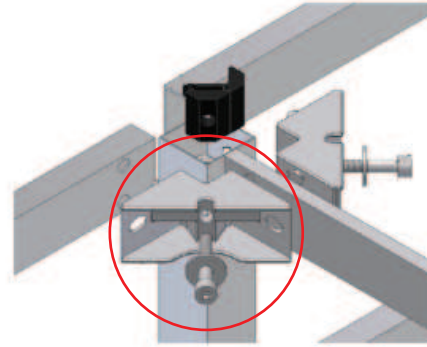

MESA SIMPLES - 8 KITS AC.1255
SIMPLE TABLE - 8 AC.1255 KITS

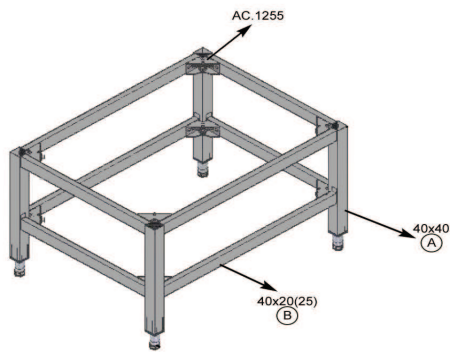

Furação / Holes

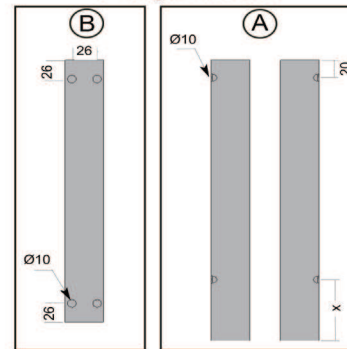

MESA TRIPLA - 8 KITS AC.1255 + 4 KITS AC.1257
TRIPLE TABLE - 8 AC.1255 KITS + 4 AC.1257 KITS

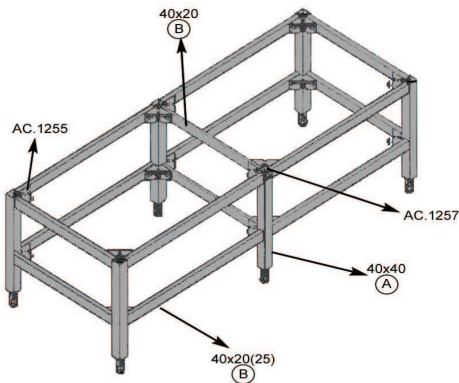

Furação / Holes

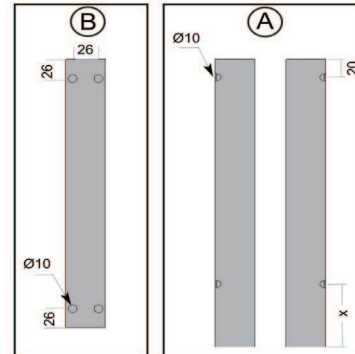

MESA TRIPLA - 8 KITS AC.1255 + 4 KITS AC.1256
TRIPLE TABLE - 8 AC.1255 KITS + 4 AC.1256 KITS

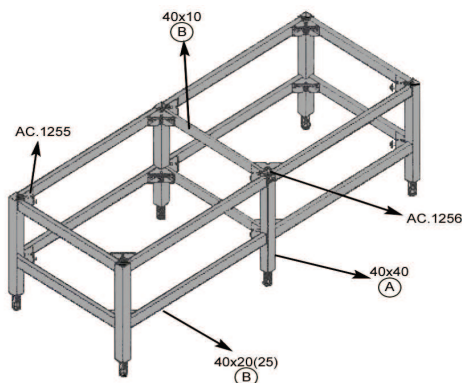

Furação / Holes

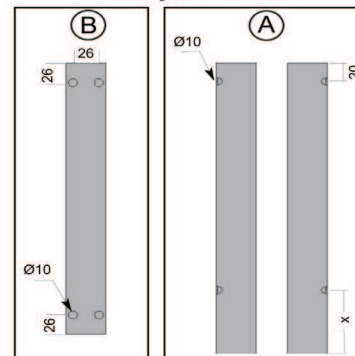

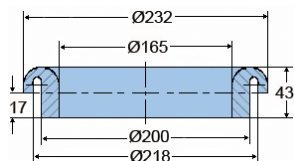
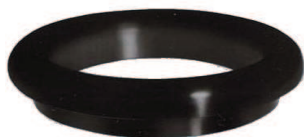

AC.1063

Gola em borracha de baixa densidade preta para detritos
Black low density rubber bumper scrap block

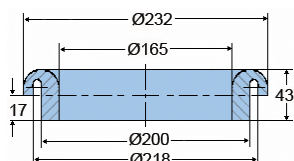

AC.1064

Gola em borracha de alta densidade para detritos
High density rubber bumper scrap block

- AC.1064** - Preto / Black
- AC.1064 A** - Azul / Blue
- AC.1064 AM** - Amarelo / Yellow
- AC.1064 V** - Verde / Green
- AC.1064 VM** - Vermelho / Red

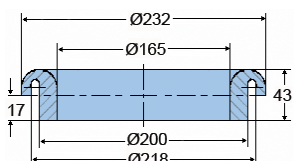

AC.1065

Gola em silicone preto para detritos
Black silicone bumper scrap block

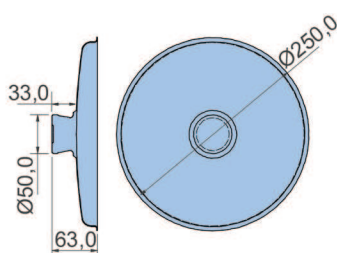

AC.1069

Tampa em inox para gola de detritos AC.1063 a AC.1065
Stainless steel scrap block lid for AC.1063 to Ac.1065

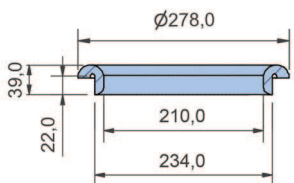

AC.1066

Gola em borracha de baixa densidade para detritos
Low density rubber bumper scrap block

- AC.1066-1** - Preto / Black
- AC.1066-1 A2** - Azul / Blue
- AC.1066-1 AM2** - Amarelo / Yellow
- AC.1066-1 V2** - Verde / Green

AC.1069-1

Tampa em aço inox para gola de detritos AC.1066

Stainless steel scrap block lid for AC.1066

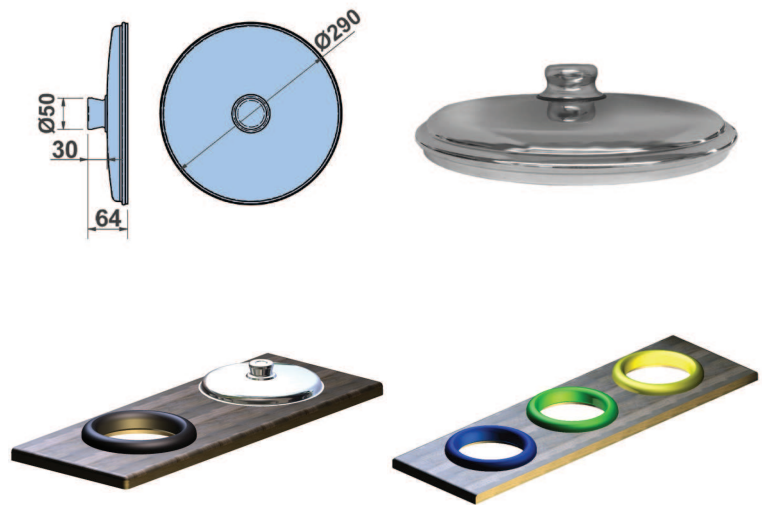

EXEMPLO DE APLICAÇÃO
EXAMPLE OF APPLICATION

AC.1068

Gola em borracha de baixa densidade cinza para detritos

Grey low density rubber bumper scrap block

AC.1068 P - Preto / Black

AC.1068 A2 - Azul / Blue

AC.1068 AM2 - Amarelo / Yellow

AC.1068 V2 - Verde / Green

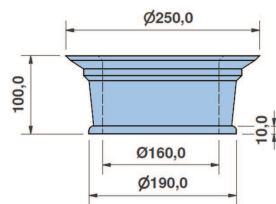

201

AC.1079

Aro em aço inox de 1mm para soldar, para AC.1068

1mm thickness stainless steel ring for welding, suitable for AC.1068

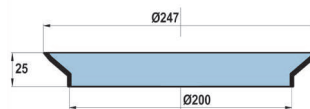

AC.1087

Batente em PVC cinza para tubo redondo

Grey PVC bumper for round tube

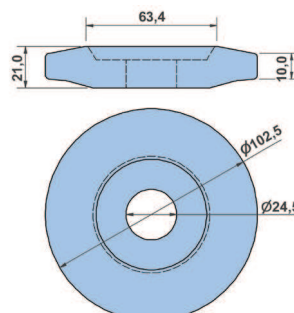

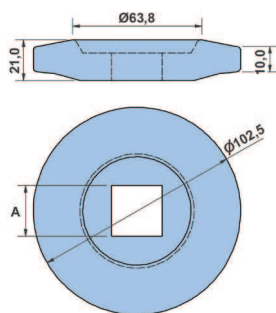

AC.1088 - AC.1088-2

Batente em PVC cinza para tubo quadrado

Grey PVC bumper for square tube

	A
AC.1088	25x25
AC.1088-1	30x30
AC.1088-2	20x20

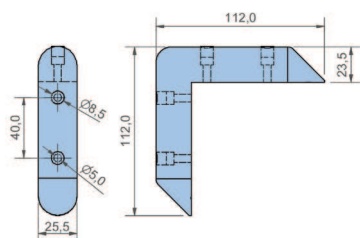

AC.1091

Canto protetor em PVC cinza

Grey PVC bumper corner

 Outras cores sob consulta
Other colours upon request

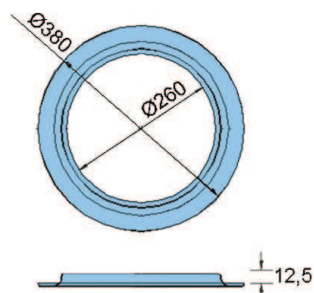

AC.1041

Olho de boi (par) em inox para porta de 40mm

AISI-304 stainless steel window ring (pair) for 40mm thick doors

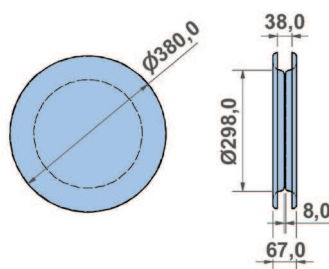
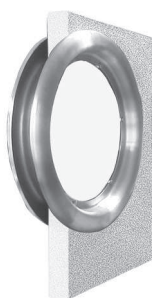

AC.2041

Conjunto Olho de Boi em aço inox AISI-304, fornecido com parafusos e visor em metacrilato com 8mm de espessura para portas de 40mm

AISI-304 stainless steel window ring(pair), supplied with screws and 8mm thick methacrylate window for 40 mm thick doors



AC.1050

Gancho em aço inox Ø8 para talho

Ø8 stainless steel butcher's hook

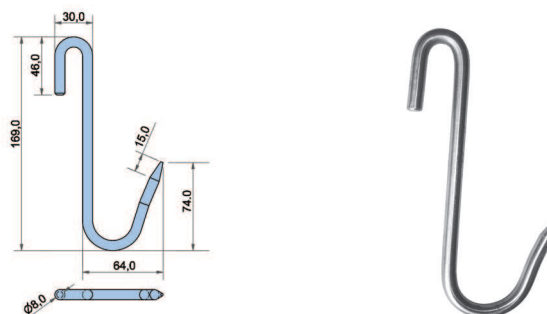

AC.1815

Ganchos "S" em aço inox para talho

"S" butcher's hooks in stainless steel

	A	Ø	B	C
AC.1815-1	60	3	20	30
AC.1815-2	80	4	28	32
AC.1815-3	100	4	30	38
AC.1815-4	120	4	34	45
AC.1815-5	140	5	36	50
AC.1815-6	160	6	40	55
AC.1815-7	180	8	50	70
AC.1815-8	200	10	55	70
AC.1815-9	220	10	60	75

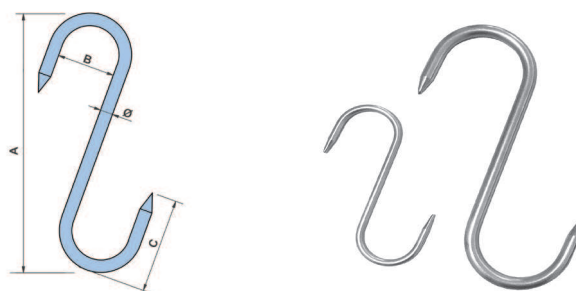

AC.1810

Tabuleiro porta talheres em polipropileno (PP) cinza com 530x325x100mm

Grey polypropylene (PP) cutlery tray with 530x325x100mm



AC.1811

Tampa em polipropileno (PP) semitransparente para tabuleiro porta talheres AC.1810

Semi-transparent polypropylene (PP) lid for cutlery tray AC.1811



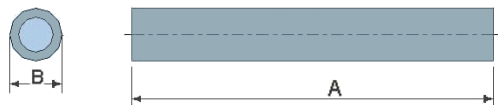

AC.1420 - 1424

Batente em borracha baixa densidade preta para tulha de café

Black low density rubber bumper for waste hopper

	A	ØB	KG
AC.1420	450	36	
AC.1421	1000	36	
AC.1422 *	328	36	
AC.1423 *	160	36	
AC.1424	350	36	

✓ * Roscado nos topos
* Threaded on ends

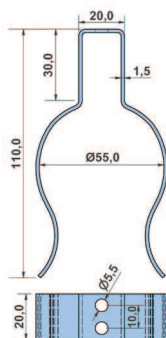
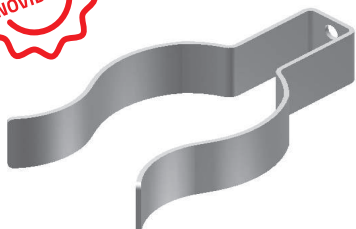

AC.1830

Mola de chapa 20x110 para fixação de rodapé em pés/tubo redondo de Ø50-65mm

Kick plate 20x110 spring clamp for round Ø50-65mm feet/tube

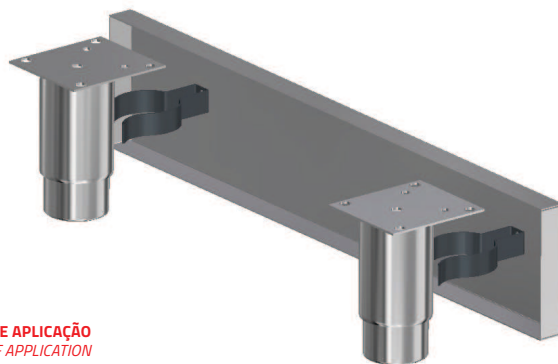

EXEMPLO DE APLICAÇÃO
EXAMPLE OF APPLICATION

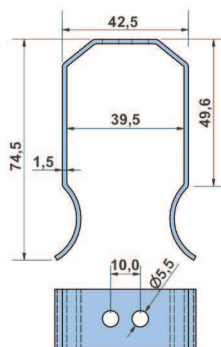

AC.1831

Mola de chapa 20x64 para fixação de rodapé em pé/tubo quadrado de 40mm

Kick plate 20x64 spring clamp for 40mm square feet/tube

AC.1832

Mola de chapa 25x60 para fixação de rodapé em pé/tubo Ø30-50mm

Kick plate 25x60 spring clamp for Ø30-50mm feet/tube

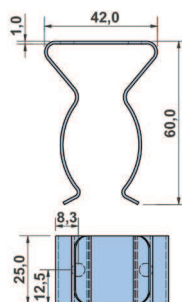

FL.100-600

Filtro de lamelas para chaminés de extração

Extractor hood blade filter

	MATERIAL <i>MATERIAL</i>	DIMENSÕES <i>DIMENSIONS</i>
FL.100	INOX AISI 304 BRILHANTE <i>BRIGHT AISI 304 STAINLESS STEEL</i>	490X490X48
FL.110	INOX AISI 430 <i>AISI 430 STAINLESS STEEL</i>	490X490X48
FL.200	AÇO GALVANIZADO <i>GALVANIZED STEEL</i>	490X490X48
FL.230	INOX AISI 430 <i>AISI 430 STAINLESS STEEL</i>	500X500X50
FL.600	INOX AISI 304 BRILHANTE <i>BRIGHT AISI 304 STAINLESS STEEL</i>	490X490X25



205

FL.220

Filtro de rede para chaminés de extração

Extractor hood mesh filter

	MATERIAL <i>MATERIAL</i>	DIMENSÕES <i>DIMENSIONS</i>
FL.220	AÇO GALVANIZADO <i>GALVANIZED STEEL</i>	490X490X48





CV.0011

Balde do lixo em inox AISI 304
Capacidade 50 Lt
Tampa removível
2 rodas Ø63
1 pega para transporte

*Stainless steel AISI 304 trash bin
50 Lt capacity
Removable lid
2 wheels Ø63
1 handle for towing*

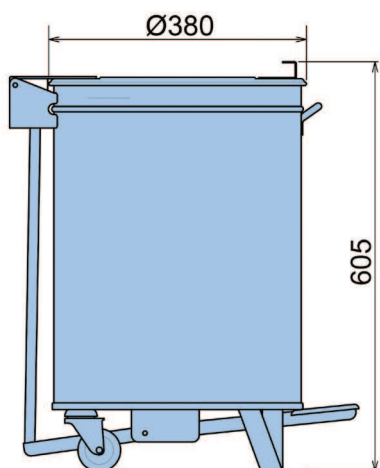



AC.1110 - 1111

Tubo de esgoto em poliamida (PA)

Polyamide (PA) drain tube

	A	B	C	D	E	F	ROSCA THREAD	COR COLOUR
AC.1110	8	2	16.6	69	24	3	3/8"	BRANCO WHITE
AC.1110 C	8	2	16.6	69	24	3	3/8"	CINZA GREY
AC.1110 P	8	2	16.6	69	24	3	3/8"	PRETO BLACK
AC.1111	9	2	26.6	90	40	4.5	3/4"	BRANCO WHITE
AC.1111 C	9	2	26.6	90	40	4.5	3/4"	CINZA GREY
AC.1111 P	9	2	26.6	90	40	4.5	3/4"	PRETO BLACK

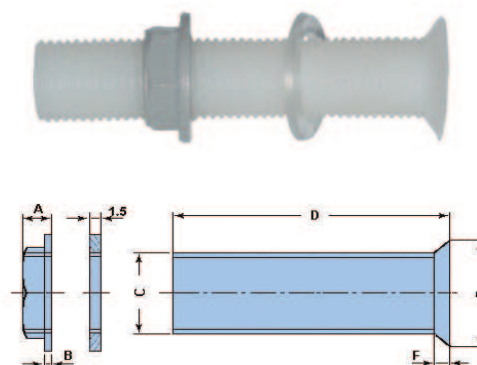

AC.1123 - 1124

Tubo de esgoto em poliamida (PA) cinza

Grey polyamide (PA) drain tube

	A	B	C	D	E	ROSCA THREAD
AC.1123	15.5	5	32	80	30	1"
AC.1124	15.5	5	42	80	39	1 1/4"

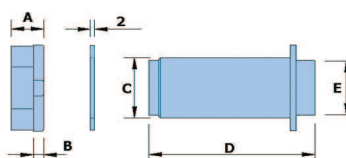

207

AC.1124-1

Tubo de esgoto em poliamida (PA) cinza

Rosca 1 1/4"

Grey polyamide (PA) drain tube

Thread 1 1/4"

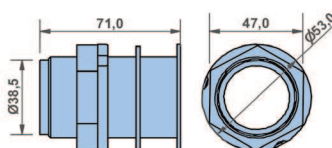

AC.1100

Tampa em poliamida (PA6) para tubo esgoto AC.1111

Polyamide (PA6) cap for AC.1111 drain tube

AC.1100 - Branco / White

AC.1100 C - Cinza / Grey

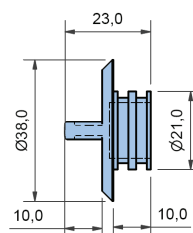

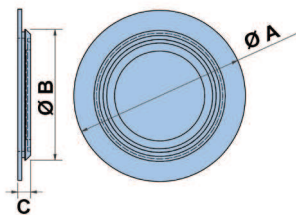

AC.1500 - 1501

Passa cabos em polipropileno (PP) preto

Black polypropylene (PP) cable protector

	A	B	C
AC.1500	68	50	5
AC.1501	68	60	5

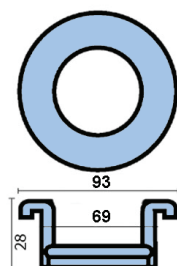

PR.40

Passa cabos em inox AISI 304

AISI 304 stainless steel cable protector



AC.1175-45

Fechadura em ABS/PC branco para armário vertical
Para porta de 45mm

White ABS/PC lock for vertical cabinets
For 45mm doors

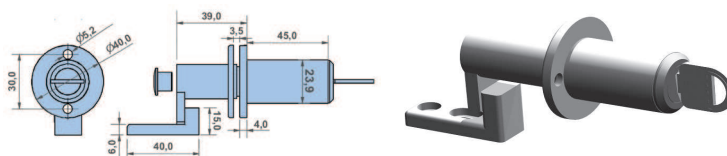

AC.1170-50

Fechadura em ABS/PC branco para armário vertical
Para porta de 50mm

White ABS/PC lock for vertical cabinets
For 50mm doors

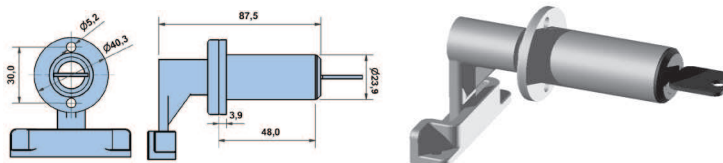

AC.1172

Bloco em ABS branco com fechadura

White ABS block with lock

AC.1172-1

Bloco em ABS branco com fechadura e sistema
de segurança;

White ABS block with lock and security system;

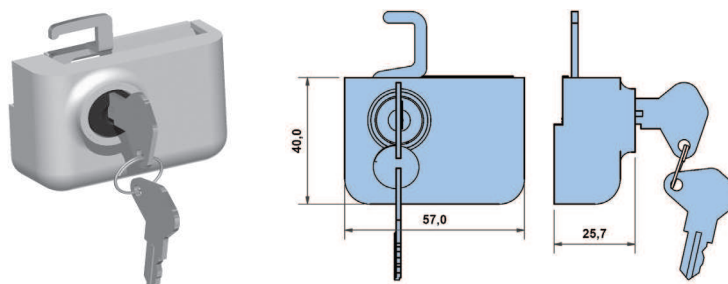

AC.1360-1363

Fecho de pressão em inox

Stainless steel pressure latch hinge

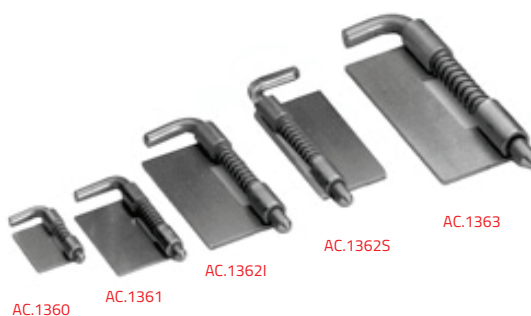

	A	C	D	E	ESPESSURA THICKNESS
AC.1360	22	3.1	12.7	4.7	0.8
AC.1361	35	3.9	19	6.3	1
AC.1362 S	50	5.0	22.2	9.5	1.5
AC.1362 I	50	5.0	22.2	9.5	1.5
AC.1363	70	6.3	25	12.7	1.5

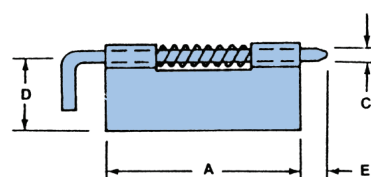

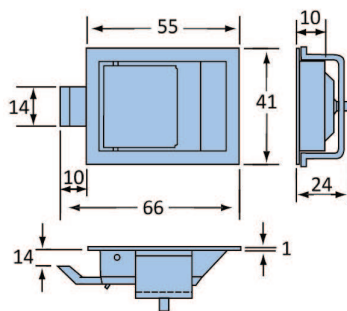

AC.1370

Fecho pala em aço inox
Stainless steel paddle latch

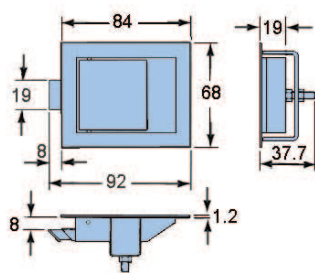

AC.1371

Fecho pala em aço inox
Stainless steel paddle latch

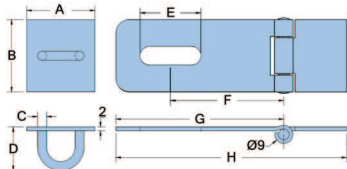
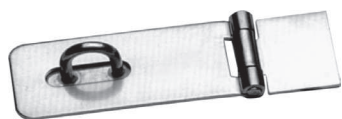

AC.1450 - AC.1451

Fecho em aço inox
Stainless steel clasp latch

	A	B	C	D	E	F	G	H
AC.1450	28	25	Ø3	18	25	48	63	94
AC.1451	36	38	Ø5	23	32	60	89	122

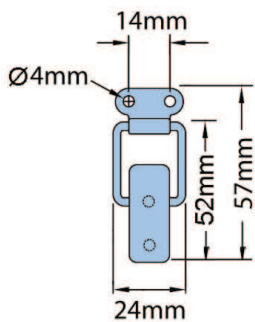

AC.1460

Fecho de pressão em aço inox
Stainless steel clasp pressure latch



AC.1461

Fecho de pressão em aço inox

Stainless steel clasp pressure latch

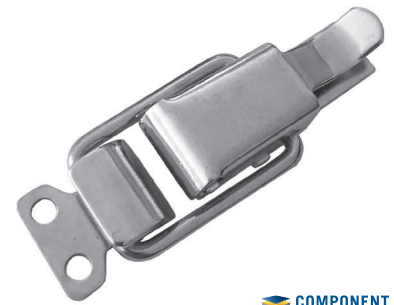
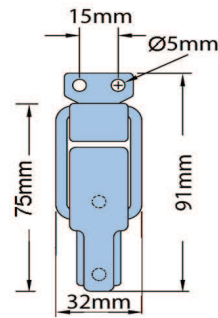

COMPONENT
HARDWARE

AC.1071 - 1074

Fecho de embutir

Spring loaded door catch

	MOLA <i>SPRING</i>	ESTRUTURA <i>STRUCTURE</i>
AC.1071	1.8MM AÇO ZINCADO <i>1.8MM ZINC PLATED STEEL</i>	AÇO ZINCADO <i>ZINC PLATED STEEL</i>
AC.1072	1.8MM AÇO INOX <i>1.8MM STAINLESS STEEL</i>	ALUMÍNIO <i>ALUMINIUM</i>
AC.1073	2.0MM AÇO ZINCADO <i>2.0MM ZINC PLATED STEEL</i>	AÇO ZINCADO <i>ZINC PLATED STEEL</i>
AC.1074	2.0MM AÇO INOX <i>2.0MM STAINLESS STEEL</i>	ALUMÍNIO <i>ALUMINIUM</i>

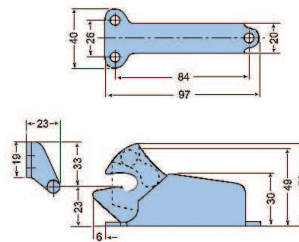

AC.1545

Fecho em aço zincado com rolete

Zinc plated steel catch with roller

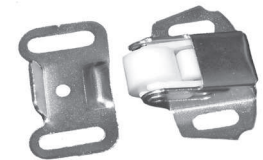
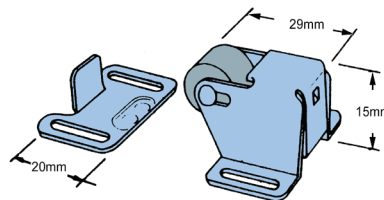

COMPONENT
HARDWARE

AC.432/50LN - 432/60LP

Fecho de dupla esfera em latão

Brass double ball catch

	ACABAMENTO <i>FINISH</i>	A	B	C	D	E	F
AC.432/50LN	NIQUELADO <i>NICKEL PLATED</i>	50	9	11	26	9	10
AC.432/50LP	POLIDO <i>POLISHED</i>	50	9	11	26	9	10
AC.432/60LN	NIQUELADO <i>NICKEL PLATED</i>	60	10	12	35	10	11.5
AC.432/60LP	POLIDO <i>POLISHED</i>	60	10	12	35	10	11.5

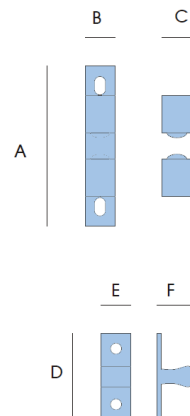

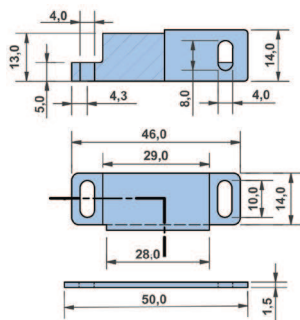

AC.1014

Fecho magnético em ABS branco

White ABS magnetic catch

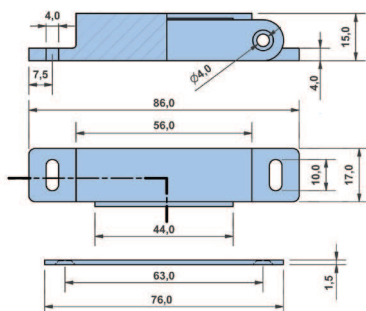

AC.1016 - AC.1016 B

Fecho magnético em ABS

ABS magnetic catch

AC.1016 - Castanho / *Brown*

AC.1016 B - Beije / *Beige*

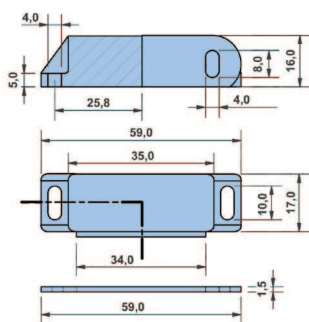

AC.1017

Fecho magnético em ABS branco

White ABS magnetic catch

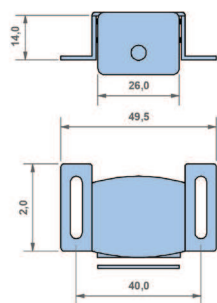
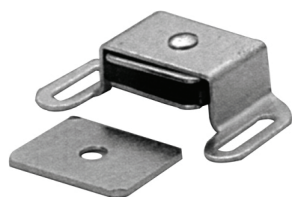

AC.1542

Fecho magnético metálico de alta resistência

Metalic high strength magnetic catch

AC.1543

Fecho magnético metálico de alta resistência

Metalic high strength magnetic catch

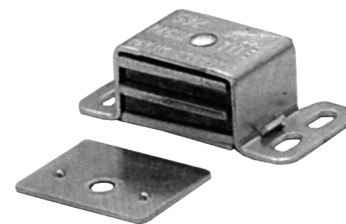
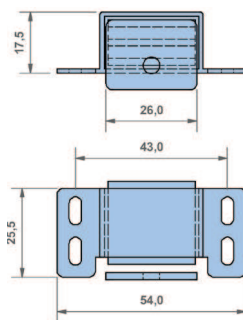

COMPONENT
HARDWARE

AC.1546

Fecho magnético metálico

Metalic magnetic catch

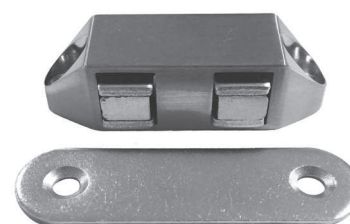
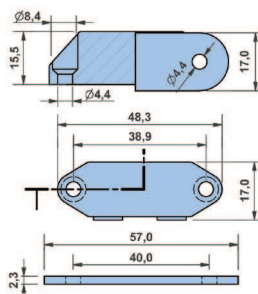

AC.1490-1492

Fechadura com frente em aço inox Ø22
Rotação a 180°

*Ø22 stainless steel faced lock
180° rotation*

	A	B	C
AC.1490	16	40	22
AC.1491	22	40	28
AC.1492	28	40	35

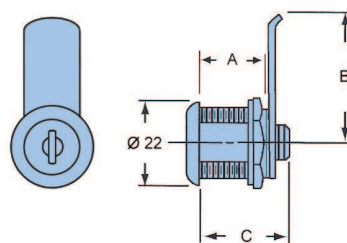

COMPONENT
HARDWARE

AC.1493 - AC.1494-4

Fechadura com frente em aço inox Ø23,5
Chaves diferentes

*Ø23,5 stainless steel faced lock
Keyed different*

	A	B
AC.1493	41	30
AC.1494	16	30
AC.1494-1	25	30
AC.1494-2	20	30
AC.1494-3	30	30
AC.1494-4	40	30

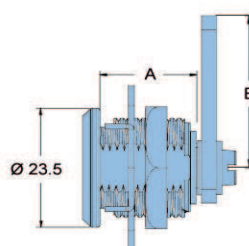

✓ Disponíveis com chaves iguais
Available keyed alike

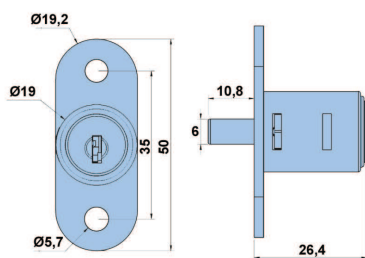

AC.1364-1

Fecho em "T" niquelado
Nickel plated plunger lock

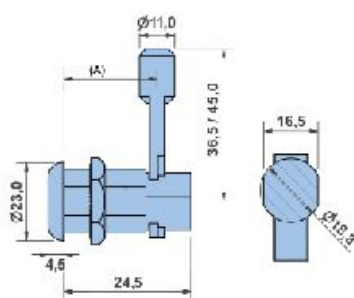

AC.1368 - AC.1368-3e AC.1368-21

Fecho em zamak com linguete redondo
Zamak lock with round bolt

AC.1368-2 - Chaves iguais / *keyed alike (A) = 21mm*
 AC.1368-21 - Chaves diferentes / *Keyed different (A) = 21mm*
 AC.1368-3 - Chaves diferentes / *Keyed different (A) = 17mm*

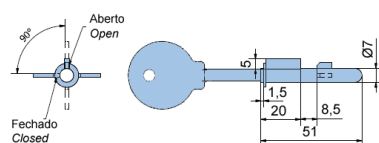

AC.1631

Fechadura para arca de gelados
Lock for ice cream freezer

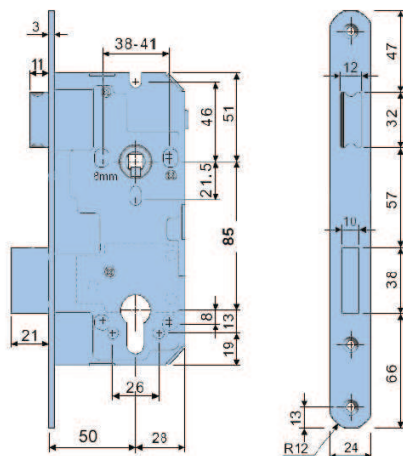

AC.1372

Fechadura para cilindro europeu com testa arredondada de 24x24mm
Lock for euro-type cylinder with rounded corners with 24x24mm

AC.1374

Fechadura para cilindro tipo europeu com testa quadrada de 235x24mm

Lock for euro-type cylinder with square corners with 235x24mm

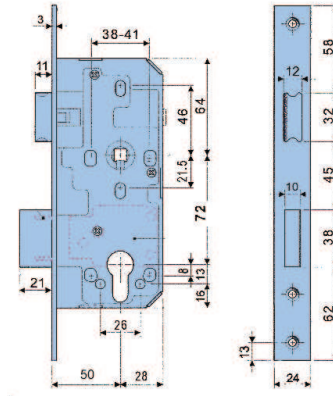

AC.1375-1384

Cilindro tipo europeu em latão niquelado

Nickel plated brass euro-type cylinder

	A	B
AC.1375	30.5	30.5
AC.1376	30.5	50.5
AC.1378 *	30.5	50.5
AC.1380 *	30.5	30.5
AC.1384 *	25.0	25.0

☑ * Com chaves iguais
* With keys alike

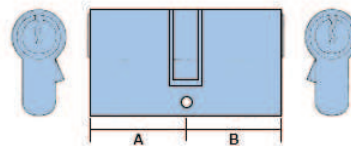

AC.1795 - AC.1796

Chapa testa em inox AISI 304

AISI 304 stainless steel strike plate

	A
AC.1795	35.0
AC.1796	36.0

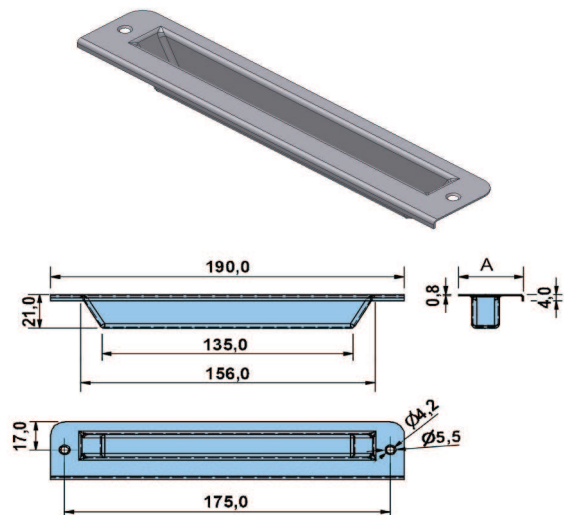

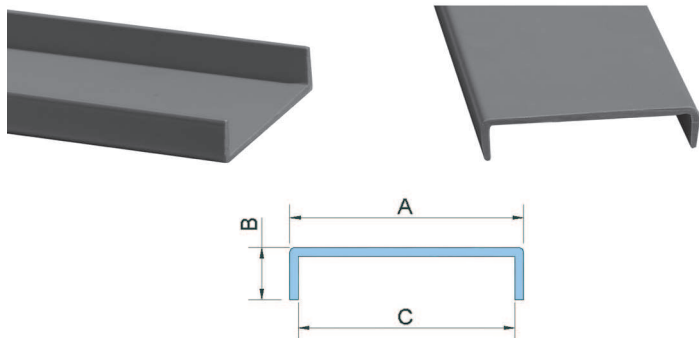

PF.AR00-AR01

Perfil em PVC cinza
Grey PVC profile

	A	B	C
PF.AR00	43.5	10	40
PF.AR01	52.5	12	50

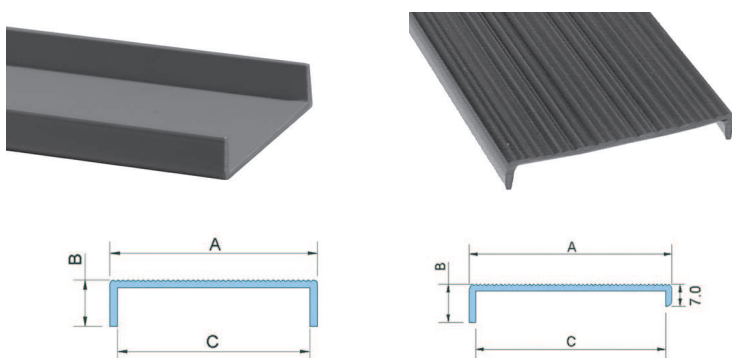

PF.AR02-AR03

Perfil em PVC preto
Black PVC profile

	A	B	C
PF.AR02	64	10	60
PF.AR03	63.3	12	60

216

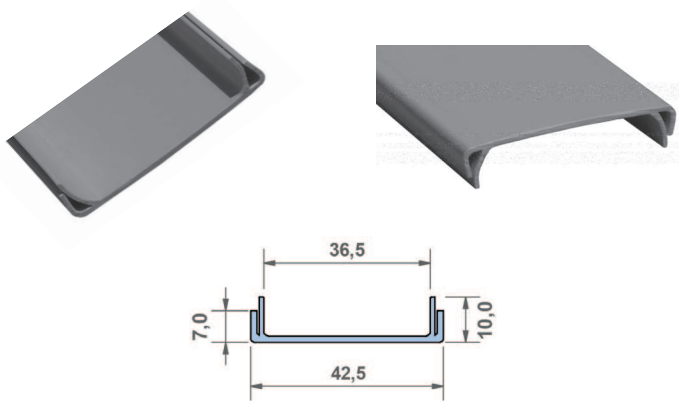

PF.AR07

Perfil em PVC
PVC profile

PF.AR07 - Preto / Black
PF.AR07 C - Cinza / Grey

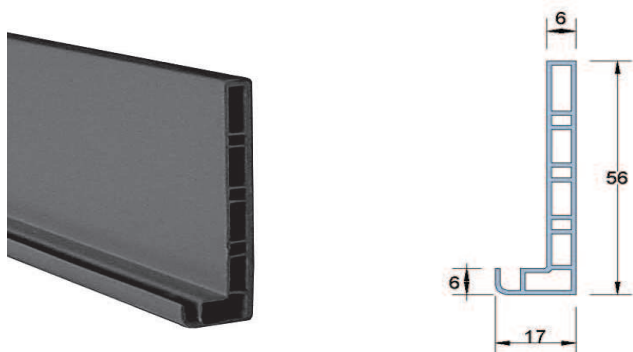

PF.201

Perfil em PVC para remate de câmara (3mts.)
PVC profile trim for cold rooms (3mts.)

PF.201 - Preto / Black
PF.201 C - Cinza / Grey



✓ Perfis soldados à medida sob consulta
Welded gaskets upon request

PF.202

Canto em poliamida (PA) para união de perfil de remate de câmara PF.201

Polyamide(PA) angle connector for PF.201 profile

PF.202 - Preto / Black
PF.202 C - Cinza / Grey

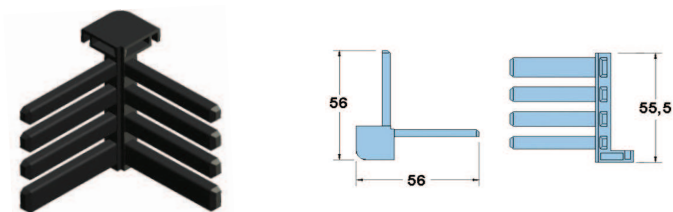

PT.1250

Perfil em PVC flexível

Opção: Com magnético

Flexible PVC profile

Option: With magnet

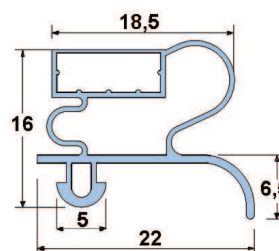

PT.1260

Perfil em PVC flexível

Opção: Com magnético

Flexible PVC profile

Option: With magnet

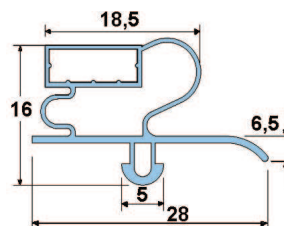

PT.1350

Perfil em PVC flexível

Opção: Com magnético

Flexible PVC profile

Option: With magnet

✓ Encaixa no perfil PT.1361;
Fits on PT.1361 profile;

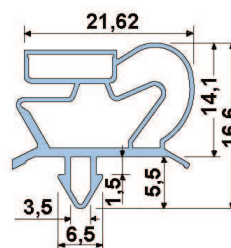

PT.1361

Perfil em PVC rígido

Rigid PVC profile

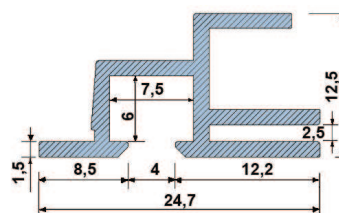



✓ Perfis soldados à medida sob consulta
Welded gaskets upon request

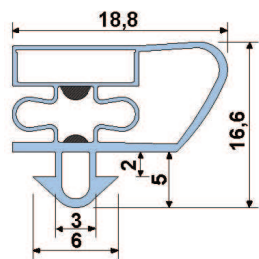

PT.1351

Perfil em PVC flexível
Opção: Com magnético

Flexible PVC profile
Option: With magnet

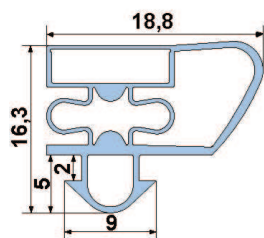

PT.1352

Perfil em PVC flexível
Opção: Com magnético

Flexible PVC profile
Option: With magnet

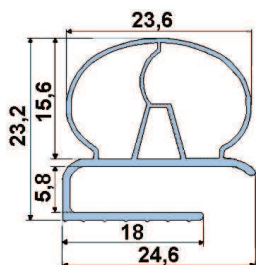

PT.1355

Perfil em PVC flexível

Flexible PVC profile

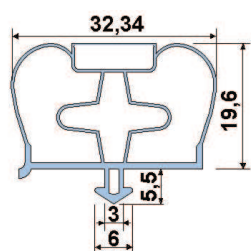

PT.1357

Perfil em PVC flexível
Opção: Com magnético

Flexible PVC profile
Option: With magnet



✓ Perfis soldados à medida sob consulta
Welded gaskets upon request

PT.1358

Perfil em PVC flexível
Opção: Com magnético

Flexible PVC profile
Option: With magnet

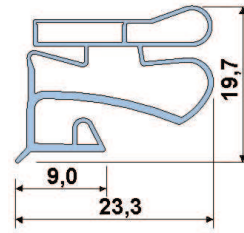

PT.1362

Perfil em borracha branca
White rubber profile

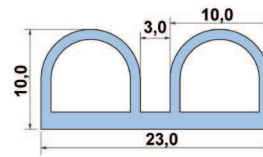

PT.1363

Perfil em borracha
Rubber profile

PT.1363 - Branco / *White*
PT.1363 P - Preto / *Black*

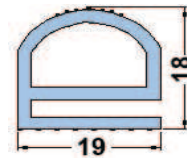

PT.1364

Perfil em silicone cinza
Grey silicone profile

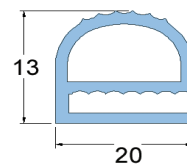

PT.1365

Perfil em PVC flexível
Flexible PVC profile

PT.1365 N - Preto / *Black*
PT.1365 G - Cinza / *Grey*

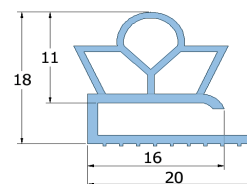

✓ Perfis soldados à medida sob consulta
Welded gaskets upon request

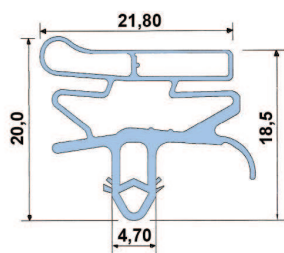

PT.1610

Perfil em PVC flexível
Opção: Com magnético

Flexible PVC profile
Option: With magnet

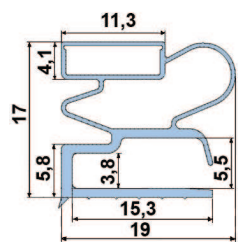

PT.1649

Perfil em PVC flexível
Opção: Com magnético

Flexible PVC profile
Option: With magnet

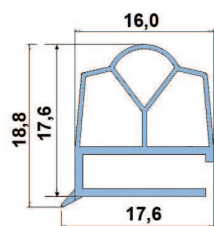

PT.1657

Perfil em PVC flexível
Flexible PVC profile

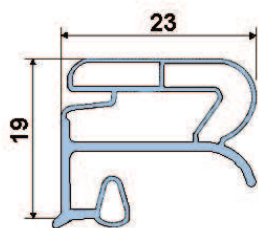

PT.1728

Perfil em PVC flexível
Opção: Com magnético

Flexible PVC profile
Option: With magnet

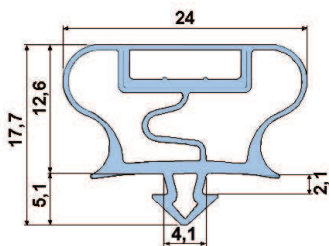

PT.1763

Perfil em PVC flexível
Opção: Com magnético

Flexible PVC profile
Option: With magnet



Perfis soldados à medida sob consulta
Welded gaskets upon request

PT.1765

Perfil em PVC flexível
Flexible PVC profile

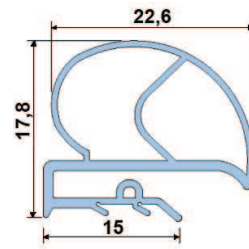

PT.1372-1373

Perfil magnético
Magnetic profile

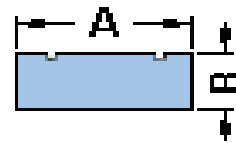

	A	B	POLARIZAÇÃO POLARIZATION
PT.1372	9.1	2.1	SNS
PT.1373	9.0	3.0	SNS

AC.1550 FI

Kit para soldadura de perfis, tesoura incluída
Kit for welding profiles, scissors included



SUPORTES AJUSTÁVEIS EM INOX AISI-316 POLIDO

ADJUSTABLE POLISHED AISI-316 STAINLESS STEEL BRACKETS

✓ Acabamento satinado sob consulta
Satin finish under request

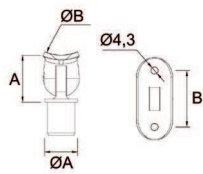

CO.SA400(X)

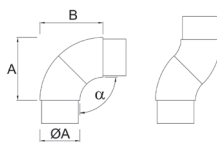

CO.SA402(X)

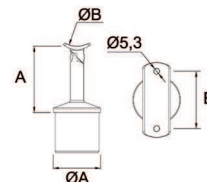

CO.SA404(X)

	ØA (MM)	ØB (MM)	A (MM)	B (MM)	α (MM)
CO.SA4004	20	43	28	48	-
CO.SA4005	20	50.8	28	48	-
CO.SA4024	43	-	65	65	90-180
CO.SA4025	50.8	-	78	78	90-180
CO.SA40433	38.1	38.1	55	48	-
CO.SA40435	38.1	50.8	55	48	-
CO.SA4044	43	43	60	52	-
CO.SA4045	50.8	50.8	65	60	-

222

✓ Acabamento satinado sob consulta
Satin finish under request

BASES EM INOX AISI-316 POLIDO PARA FIXAÇÃO

POLISHED AISI-316 STAINLESS STEEL BASES FOR FIXATION

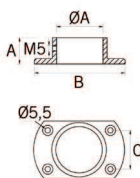

CO.AV600(X)

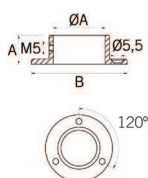

CO.AV601(X)

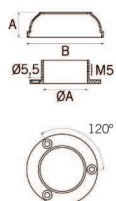

CO.AV602(X)

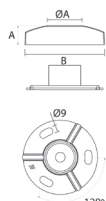

CO.AV603(X)

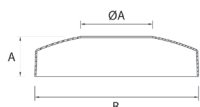
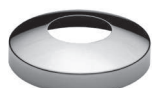

CO.AV650(X)



	ØA (MM)	A (MM)	B (MM)	C (MM)
CO.AV6003	38.1	34	75	28
CO.AV6004	43	35	85	34
CO.AV6005	50.8	36	96	39
CO.AV6013	38.1	24	75	-
CO.AV6014	43	25	80	-
CO.AV6015	50.8	31	102	-
CO.AV6023	38.1	25	73	-
CO.AV6024	43	26	82	-
CO.AV6025	50.8	29	85	-
CO.AV6033	38.1	22.5	99	-
CO.AV6034	43	22.5	99	-
CO.AV6035	50.8	22.5	99	-
CO.AV6502	20	11.5	55	-
CO.AV6503	38.1	22.5	99	-
CO.AV6504	43	22.5	99	-
CO.AV6505	50.8	22.5	99	-
CO.AV6506	63.5	24	110	-



LIGAÇÕES EM INOX AISI-316 POLIDO
POLISHED AISI-316 STAINLESS STEEL CONNECTIONS

✓ Para tubo de 1,5mm espessura
 For 1,5mm tube thickness

✓ Acabamento satinado sob consulta
 Satin finish under request

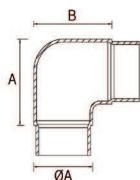

CO.CT200(X)

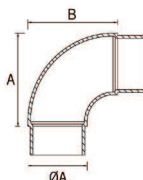

CO.CT201(X)

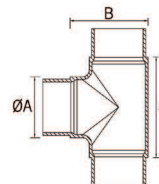

CO.CT202(X)

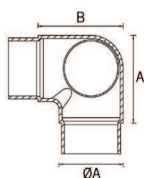

CO.CT205(X)

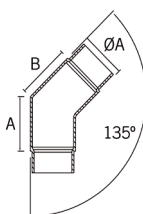

CO.CT206(X)

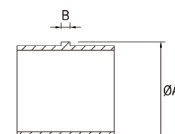

CO.CT207(X)



	ØA (MM)	A (MM)	B (MM)
CO.CT2004	43	55	55
CO.CT2005	50.8	60	60
CO.CT2012	20	30	30
CO.CT2014	43	55	55
CO.CT2015	50.8	60	60
CO.CT2024	43	71	57
CO.CT2025	50.8	69	60
CO.CT2054	43	55	55
CO.CT2055	50.8	60	60
CO.CT2064	43	50	55
CO.CT2065	50.8	50	60
CO.CT2071	12	-	2
CO.CT2072	20	-	4
CO.CT2073	38.1	-	4
CO.CT2074	43	-	4
CO.CT2075	50.8	-	4
CO.CT2083	38.1	83	75
CO.CT2084	43	90	80
CO.CT2085	50.8	95	102

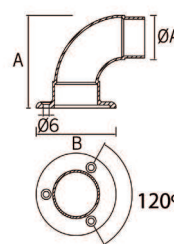

CO.CT208(X)



REMATES EM INOX AISI-316 POLIDO

POLISHED AISI-316 STAINLESS STEEL TRIMS

✓ Para tubo de 1,5mm espessura
For 1,5mm tube thickness

✓ Acabamento satinado sob consulta
Satin finish under request

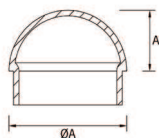

CO.TF501(X)

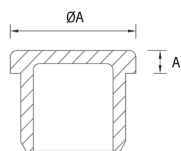

CO.TF502(X)

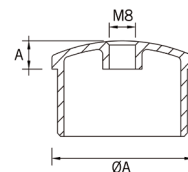

CO.TF503(X)

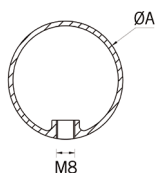

CO.TF504(X)

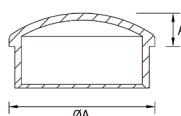

CO.TF505(X)

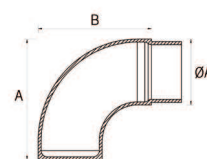

CO.TF5065(X)

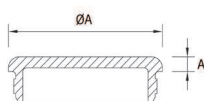

CO.TF507(X)

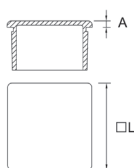

CO.TF530

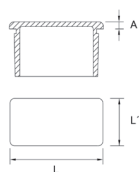

CO.TF535



	ØA (MM)	A (MM)	B (MM)	L (MM)	L' (MM)
CO.TF5013	38.1	19.5	-	-	-
CO.TF5014	43	21.5	-	-	-
CO.TF5015	50.8	25	-	-	-
CO.TF50212	12	2	-	-	-
CO.TF50215	15	2	-	-	-
CO.TF50218	18	2	-	-	-
CO.TF50220	20	2	-	-	-
CO.TF50225	25	2	-	-	-
CO.TF50230	30	2	-	-	-
CO.TF50233	33	2	-	-	-
CO.TF5023	38.1	2	-	-	-
CO.TF50240	40	2	-	-	-
CO.TF5024	43	2	-	-	-
CO.TF5025	50.8	2	-	-	-
CO.TF5026	63.5	2	-	-	-
CO.TF5034	43	8.4	-	-	-
CO.TF5035	50.8	8.4	-	-	-
CO.TF5045	50	-	-	-	-
CO.TF5047	70	-	-	-	-
CO.TF5053	-	-	-	-	-
CO.TF5054	-	-	-	-	-
CO.TF5055	-	-	-	-	-
CO.TF5065	50.8	83	80	80	80
CO.TF5074	43	4	-	-	-
CO.TF5075	50.8	4	-	-	-
CO.TF53030	-	3	-	30X40	-
CO.TF53040	-	3	-	40X40	-
CO.TF53520	-	3	-	20	10
CO.TF53540	-	3	-	40	20



SUPORTES EM INOX AISI-316 POLIDO
POLISHED AISI-316 STAINLESS STEEL SUPPORTS

✓ Acabamento satinado sob consulta
 Satin finish under request

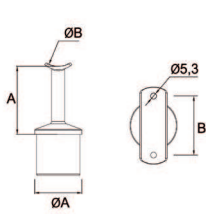

CO.ST302(X)

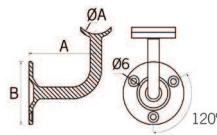

CO.ST303(X)

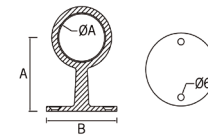

CO.ST304(X)

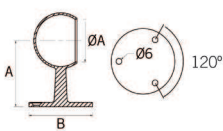

CO.ST305(X)

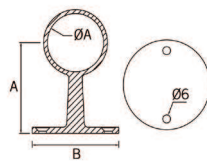

CO.ST306(X)

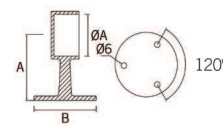

CO.ST307(X)



	ØA (MM)	ØB (MM)	A (MM)	B (MM)
CO.ST30233	38.1	38.1	55	48
CO.ST30235	38.1	50.8	55	48
CO.ST3024	43	43	60	52
CO.ST3025	50.8	50.8	65	60
CO.ST3034	43	-	70	63
CO.ST3035	50.8	-	70	63
CO.ST3043	38.1	-	69	57
CO.ST3044	43	-	68	67
CO.ST3045	50.8	-	78	80
CO.ST3053	38.1	-	69	57
CO.ST3054	43	-	68	67
CO.ST3055	50.8	-	78	80
CO.ST3064	43	-	72	69
CO.ST3065	50.8	-	83	63
CO.ST3074	43	-	72	69
CO.ST3075	50.8	-	83	63
CO.ST3082	20	-	4	-
CO.ST30924	20	43	4	-
CO.ST30925	20	50.8	4	-
CO.ST30933	38.1	38.1	17	-
CO.ST30935	38.1	50.8	9	-
CO.ST30944	43	43	12	-
CO.ST30955	50.8	50.8	9	-
CO.ST31024	20	43	4	-
CO.ST31025	20	50.8	4	-
CO.ST31033	38.1	38.1	5	-
CO.ST31035	38.1	50.8	5	-
CO.ST31044	43	43	5	-
CO.ST31055	50.8	50.8	5	-

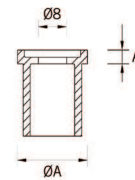

CO.ST3082

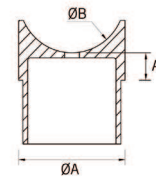

CO.ST309(X)

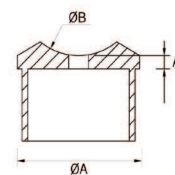

CO.ST310(X)



SUPORTES EM INOX AISI-316 POLIDO
POLISHED AISI-316 STAINLESS STEEL SUPPORTS

☑ Acabamento satinado sob consulta
Satin finish under request

☑ * Indicar se direita ou esquerda no pedido
** Indicate if right or left when ordering*

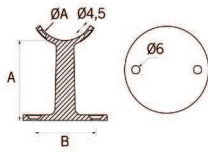

CO.ST311(X)

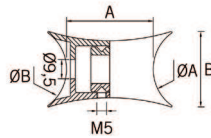

CO.ST312(X)

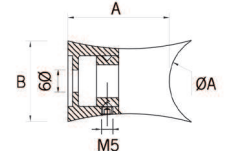

CO.ST313(X)

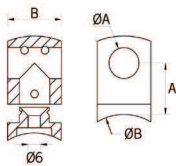

CO.ST320(X)

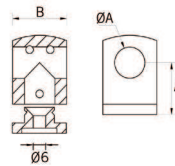

CO.ST321(X)

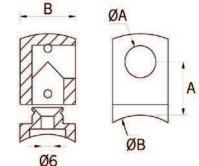

CO.ST322(X)

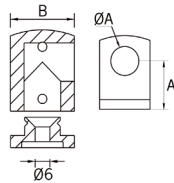

CO.ST323(X)

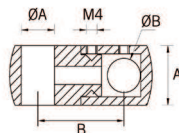

CO.ST324

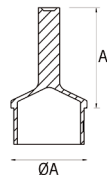

CO.ST330(X)

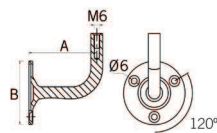

CO.ST351



	ØA (MM)	ØB (MM)	A (MM)	B (MM)
CO.ST3114	43	-	57	62.5
CO.ST3115	50.8	-	57	62.5
CO.ST3124	43	43	44	37
CO.ST3125	50.8	50.8	44	37
CO.ST313	40	-	44	34
CO.ST32024	12	43	20	21
CO.ST32025	12	50.8	20	21
CO.ST32044	14	43	21	23
CO.ST32045	14	50.8	21	23
CO.ST32064	16	43	25	26
CO.ST32065	16	50.8	25	26
CO.ST32004	20	43	25	30
CO.ST32005	20	50.8	25	30
CO.ST32122	12	-	20	21
CO.ST32142	14	-	21	23
CO.ST32162	16	-	25	26
CO.ST32102	20	-	25	30
CO.ST32224 *	12	43	20	21
CO.ST32225 *	12	50.8	20	21
CO.ST32264 *	16	43	25	23
CO.ST32265 *	16	50.8	25	23
CO.ST32204 *	20	43	25	30
CO.ST32205 *	20	50.8	25	30
CO.ST32322 *	12	-	20	21
CO.ST32362 *	16	-	25	26
CO.ST32302 *	20	-	25	30
CO.ST324	12	12	21	25
CO.ST3303	38.1	-	55	-
CO.ST3304	43	-	55	-
CO.ST3305	50.8	-	55	-
CO.ST351	-	-	70	63



CLIPS EM INOX AISI-316 POLIDO PARA VIDRO
POLISHED AISI-316 STAINLESS STEEL CLIPS FOR GLASS

✓ Acabamento satinado sob consulta
Satin finish under request

✓ * Indicar se direita ou esquerda no pedido
** Indicate if right or left when ordering*

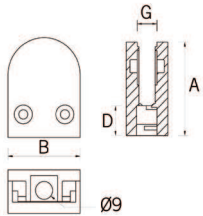

CO.CC700(X)

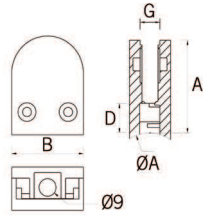

CO.CC701(X)

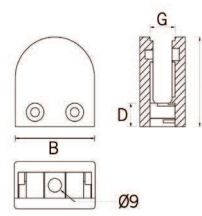

CO.CC702(X)

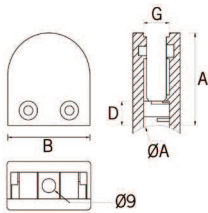

CO.CC703(X)

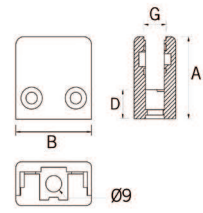

CO.CC720

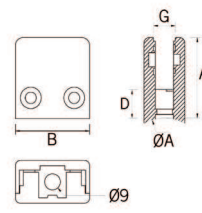

CO.CC721(X)



	ØA (MM)	A (MM)	B (MM)	D (MM)	G (MM)
CO.CC7000	-	50	40	16	6-8
CO.CC7001	-	50	40	16	8-10
CO.CC7013	38.1	50	40	16	6-8
CO.CC7014	43	50	40	16	6-8
CO.CC7015	50.8	50	40	16	6-8
CO.CC7014	43	50	40	16	8-10
CO.CC7015	50.8	50	40	16	8-10
CO.CC70151	50.8	50	40	16	10-12
CO.CC70141	43	50	40	16	10-12
CO.CC702	-	60	55	15.5	10-12
CO.CC70331	38.1	60	55	15.5	10-12
CO.CC70341	43	60	55	15.5	10-12
CO.CC70351	50.8	60	55	15.5	10-12
CO.CC7200	-	45	45	16	8-10
CO.CC72148	43	45	45	16	8-10
CO.CC72158	50.8	45	45	16	8-10
CO.CC75056 *	-	50	40	16	6-8
CO.CC75058 *	-	50	40	16	8-10
CO.CC75146 *	43	50	40	16	6-8
CO.CC75156 *	50.8	50	40	16	6-8
CO.CC75148 *	43	50	40	16	8-10
CO.CC75158 *	50.8	50	40	16	8-10

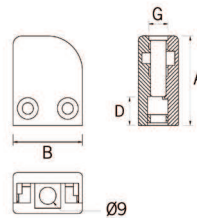

CO.CC750(X)

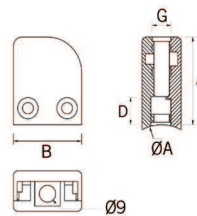

CO.CC751(X)



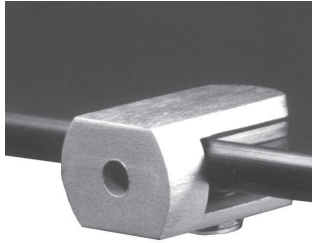

AC.1560

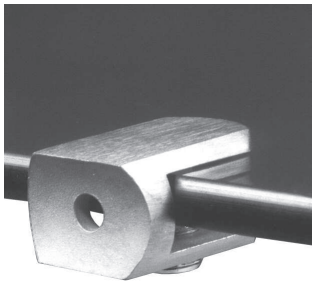
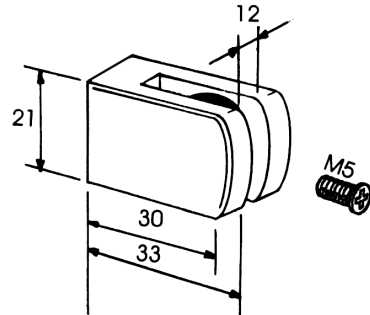

AC.1561

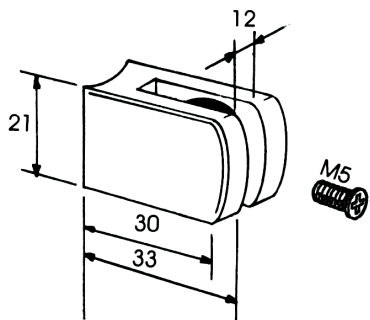

AC.1562 - AC.1564

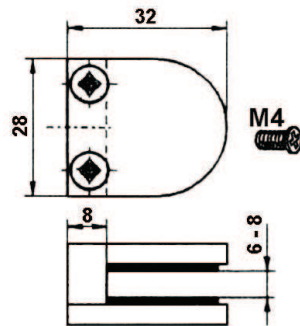

AC.1563 - AC.1565

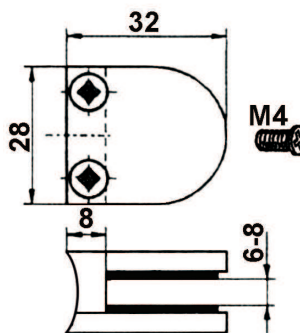

AC.1560 - AC.1565

Clip em inox AISI 316 para superfícies planas e tubo redondo

AISI 316 stainless steel clip for flat surfaces and round tube

	Ø TUBO (MM) Ø TUBE (MM)	VIDRO (MM) GLASS (MM)
AC.1560	-	4-10
AC.1561	30	4-10
AC.1562	-	6
AC.1563	30	6
AC.1564	-	8
AC.1565	30	8

EMBELEZADORES LISOS EM INOX AISI-304

AISI-316 STAINLESS STEEL PLAIN COVERS

SEM FURO *WITHOUT HOLE*

	A (MM)	B (MM)	C (MM)
MI.LGC	110	15	-
MI.LPC	67	12	-

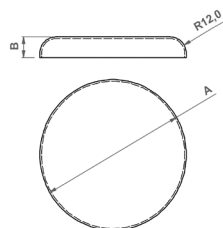

PARA TUBO REDONDO *FOR ROUND TUBE*

	A (MM)	B (MM)	C (MM)
MI.LGT30	110	15	30
MI.LGT35	110	15	35
MI.LGT38	110	15	38
MI.LGT40	110	15	40
MI.LGT43	110	15	43
MI.LGT50	110	15	50
MI.LGT53	110	15	53
MI.LGT63	110	15	63
MI.LPT12	67	12	12
MI.LPT16	67	12	16
MI.LPT18	67	12	18
MI.LPT20	67	12	20
MI.LPT25	67	12	25
MI.LPT28	67	12	28

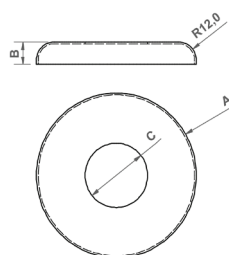

PARA TUBO QUADRADO *FOR SQUARE TUBE*

	A (MM)	B (MM)	C (MM)
MI.LGT4040	110	15	40
MI.LGT3030	110	15	30

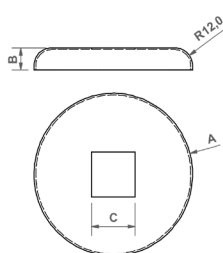

PARA TUBO E BARRA RETANGULAR *FOR RECTANGULAR TUBE AND BAR*

FOR RECTANGULAR TUBE AND BAR

	A (MM)	B (MM)	C (MM)	D (MM)
MI.LGT4020	110	15	40	20
MI.LGP4	110	15	40	8-10
MI.LPG5	110	15	50	8-10

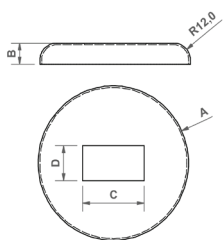



mm



Kg



mm

Não é permitida a reprodução integral ou parcial do catálogo sem autorização expressa da Fajota, S.A.
A Fajota, S.A. reserva-se o direito de efectuar alterações aos produtos sem informação prévia.
As dimensões e pesos apresentados são meramente indicativos podendo variar ligeiramente.

*Complete or partial reproduction of this catalogue is not allowed without the express permission of Fajota, S.A.
Fajota, S.A. reserves the right to make changes to products without prior notice.
The dimensions and weights presented are merely indicative and may suffer variations.*

CONTACTE-NOS PARA MAIS INFORMAÇÕES OU VISITE O NOSSO SITE
CONTACT US FOR MORE INFORMATION OR VISIT OUR WEBSITE

FAJOTA.PT